

**APPENDIX B**

Post Construction Stormwater Management

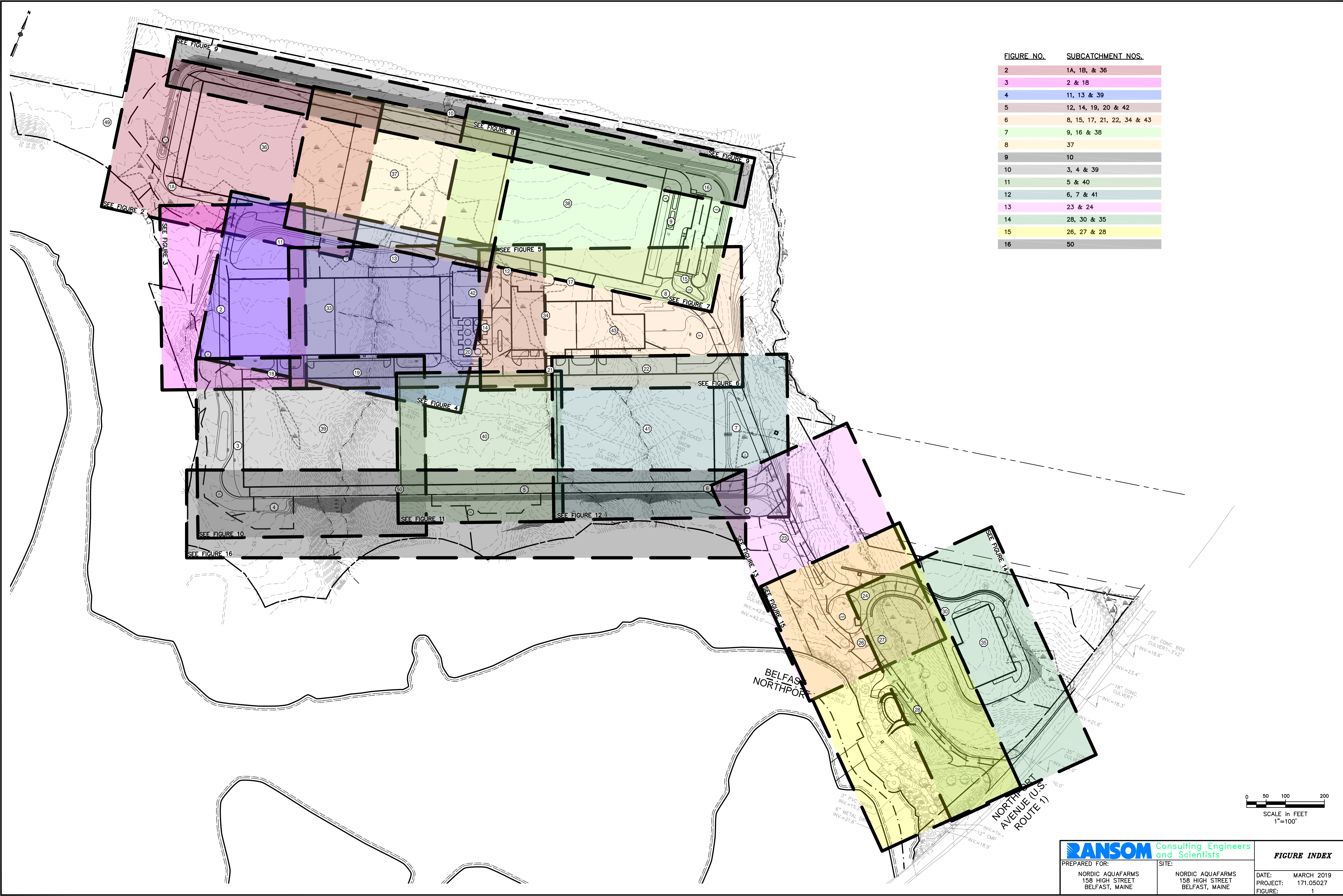
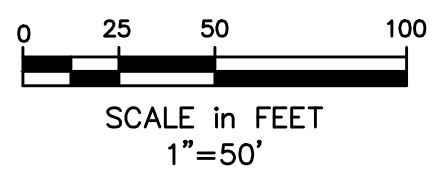
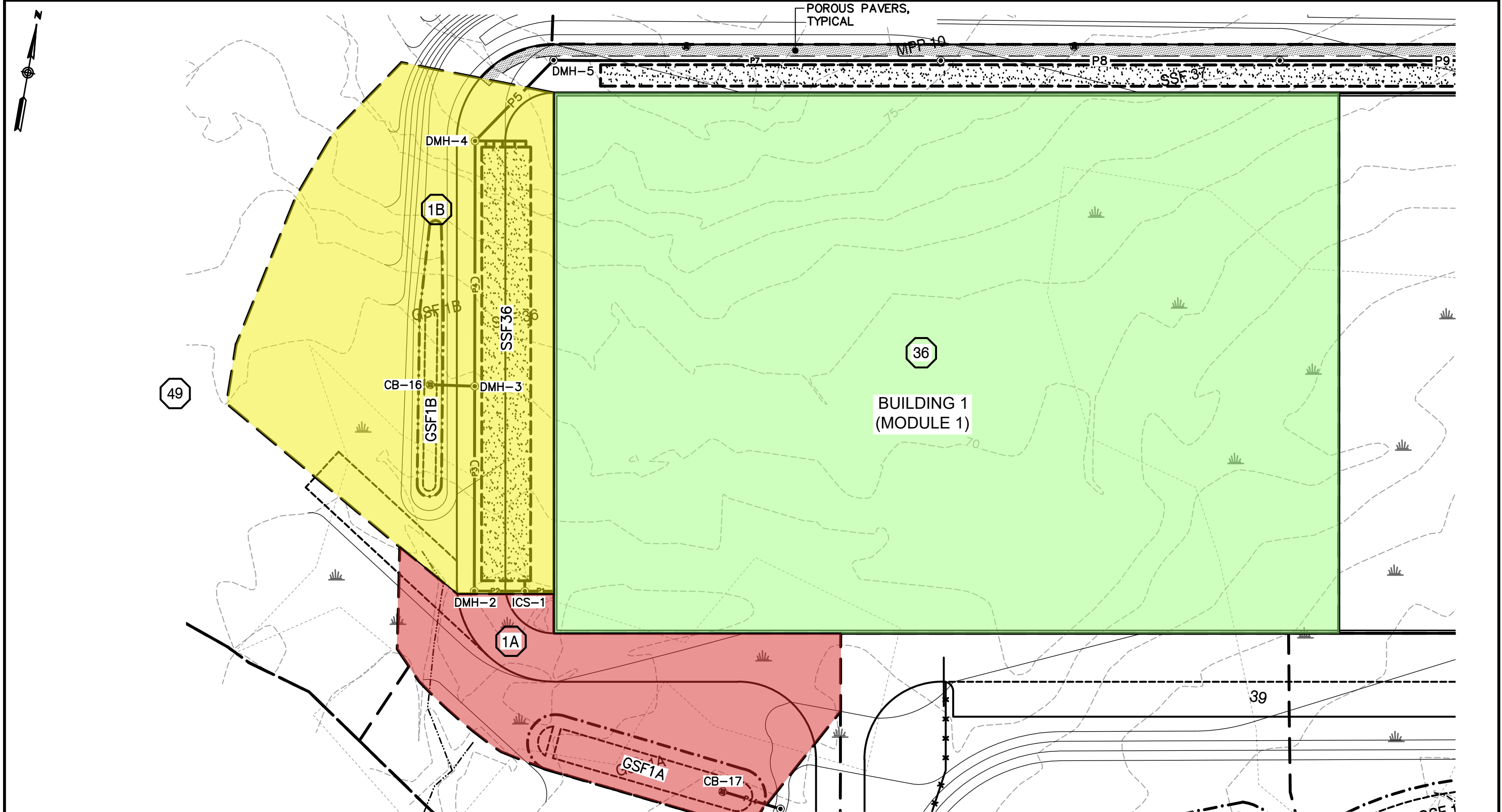

FIGURE NO.	SUBCATCHMENT NOS.
2	1A, 1B, & 36
3	2 & 18
4	11, 13 & 39
5	12, 14, 19, 20 & 42
6	8, 15, 17, 21, 22, 34 & 43
7	9, 16 & 38
8	37
9	10
10	3, 4 & 39
11	5 & 40
12	6, 7 & 41
13	23 & 24
14	28, 30 & 35
15	26, 27 & 28
16	50

		<b>FIGURE INDEX</b>	
PREPARED FOR:	SITE:	DATE:	MARCH 2019
NORDIC AQUAFARMS 158 HIGH STREET BELFAST, MAINE	NORDIC AQUAFARMS 158 HIGH STREET BELFAST, MAINE	PROJECT:	171.05027
		FIGURE:	1

3/19/2019 7:16 PM 171.05027.DWG - SWP - INRECLD.WG



		<b>SUBCATCHMENTS 1A, 1B &amp; 36</b>	
		PREPARED FOR: NORDIC AQUAFARMS 158 HIGH STREET BELFAST, MAINE	SITE: NORDIC AQUAFARMS 158 HIGH STREET BELFAST, MAINE

**Figure 2**

**Structures**

Structure	Rim Elevation	Inlets		Outlets		Weir Elevation
		Pipe Dia. (in.)	Elevation	Pipe Dia. (in.)	Elevation	
ICS-1	69.38	18	64.60	12	63.15	66.16
				18	63.50	
DMH-2	69.15	18	63.27	18	63.00	-
DMH-3	68.85	8	62.60	18	60.50	-
		18	61.50			
DMH-4	68.60	6	60.55	18	59.84	-
		18	59.87			

**Catch Basins**

Structure	Rim Elevation	Inlets		Outlets	
		Pipe Dia. (in.)	Elevation	Pipe Dia. (in.)	Elevation
CB-16	66.70	6	63.25	8	63.00
CB-17	66.30	6	63.00	8	62.80

**Piping**

Pipe	Pipe Dia (in.)	From		To		Length (ft)	Slope (ft/ft)
		Structure	Elevation	Structure	Elevation		
P1	18	B1M1	64.93	ICS-1	64.6	13	0.025
P2	18	ICS-1	63.5	DMH-2	63.27	23	0.010
P3	18	DMH-2	63	DMH-3	61.5	100	0.015
P4	18	DMH-3	60.5	DMH-4	59.87	125	0.005
P5	18	DMH-4	59.84	DMH-5	59.51	66	0.005
P6	8	CB-16	63	DMH-3	62.6	20	0.020
P44	8	CB-17	62.8	DMH-25	62.26	27	0.020

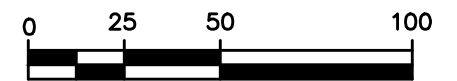
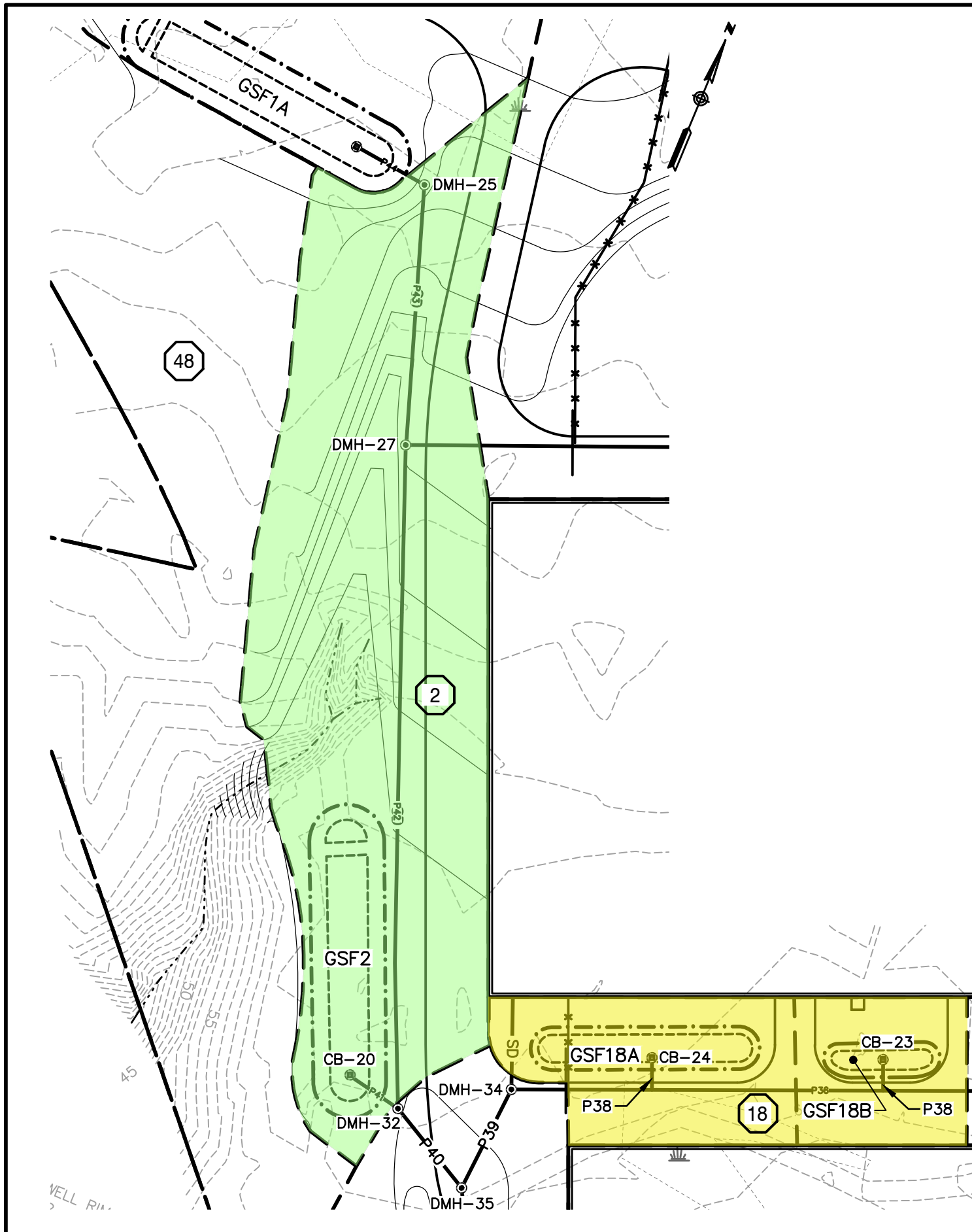

SCALE in FEET  
1"=50'

		<b>SUBCATCHMENTS 2 &amp; 18</b>	
		DATE: MARCH 2019	PROJECT: 171.05027
PREPARED FOR: NORDIC AQUAFARMS 158 HIGH STREET BELFAST, MAINE	SITE: NORDIC AQUAFARMS 158 HIGH STREET BELFAST, MAINE	FIGURE: 3	

**Figure 3****Structures**

Structure	Rim Elevation	Inlets		Outlets		Weir Elevation
		Pipe Dia. (in.)	Elevation	Pipe Dia. (in.)	Elevation	
DMH-25	67	8	62.26	12	60.00	-
DMH-27	63	15	53.05	15	53.03	-
		12	55.00			

**Catch Basins**

Structure	Rim Elevation	Inlets		Outlets	
		Pipe Dia. (in.)	Elevation	Pipe Dia. (in.)	Elevation
CB-20	57.60	6	54	8	53.95
CB-23	57.90	6	54.25	6	54.00
CB-24	57.40	6	54.25	6	54.00

**Piping**

Pipe	Pipe Dia (in.)	From		To		Length (ft)	Slope (ft/ft)
		Structure	Elevation	Structure	Elevation		
P36	12	DMH-33	54	DMH-34	52.01	201	0.010
P37	6	CB-23	54	P36	53.95	11	0.005
P38	6	CB-24	54	P36	53.95	11	0.005
P41	8	CB-20	53.95	DMH-32	53.76	19	0.010
P42	15	DMH-27	53.03	DMH-32	51.75	256	0.005
P43	12	DMH-25	60	DMH-27	55	98	0.051
P44	8	CB-17	62.8	DMH-25	62.26	27	0.020
P45	15	DMH-31	54.35	DMH-27	53.05	259	0.005

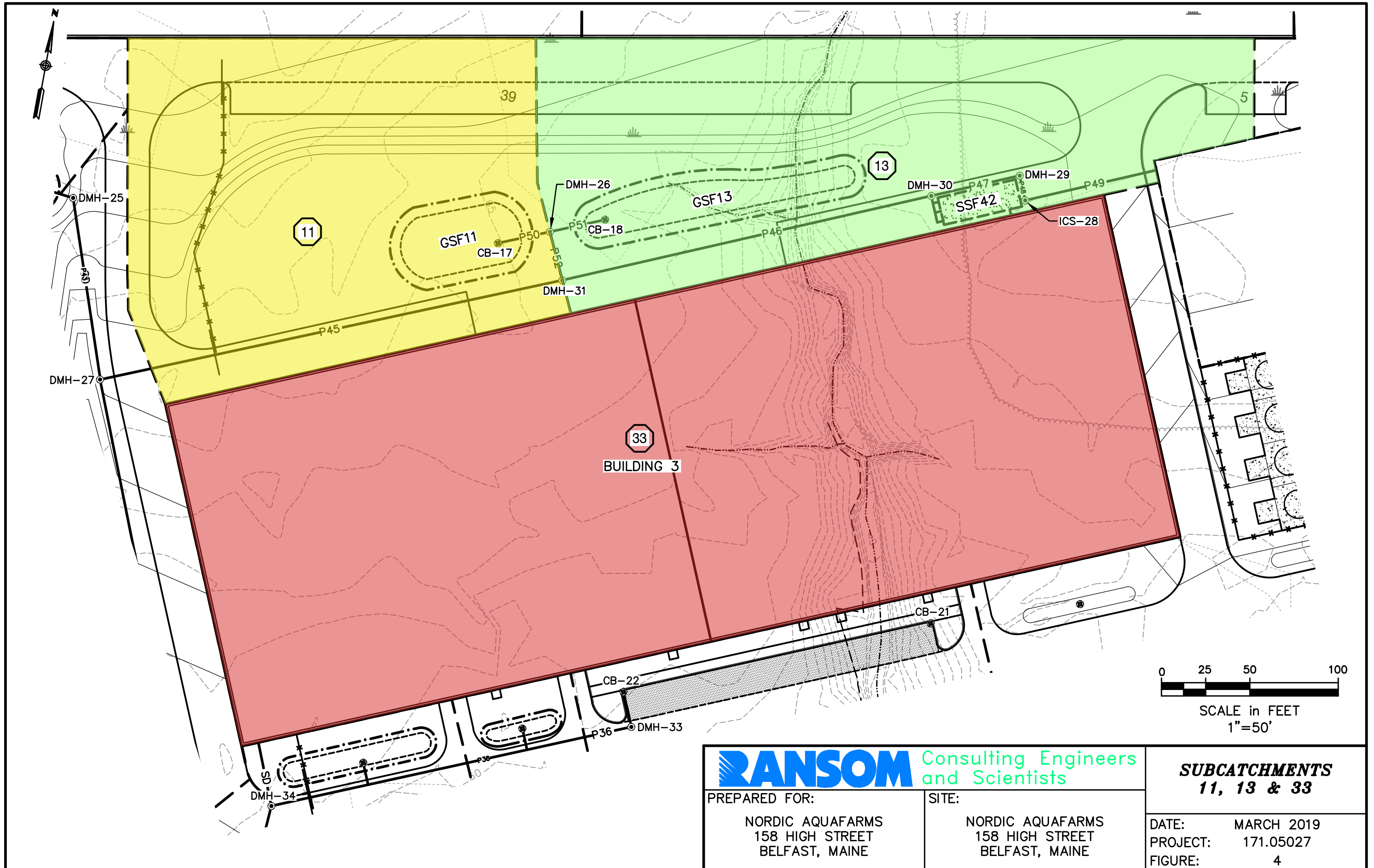

**RANSOM** Consulting Engineers and Scientists

PREPARED FOR:  
 NORDIC AQUAFARMS  
 158 HIGH STREET  
 BELFAST, MAINE

SITE:  
 NORDIC AQUAFARMS  
 158 HIGH STREET  
 BELFAST, MAINE

**SUBCATCHMENTS**  
**11, 13 & 33**

DATE: MARCH 2019  
 PROJECT: 171.05027  
 FIGURE: 4

**Figure 4**

**Structures**

Structure	Rim Elevation	Inlets		Outlets		Weir Elevation
		Pipe Dia. (in.)	Elevation	Pipe Dia. (in.)	Elevation	
DMH-26	63	12	57.82	12	57.75	-
		12	57.78			
ICS-28	63.95	8	58.85	8	58.15	60.50
				8	58.00	
DMH-29	63.5	8	57.90	8	57.85	-
DMH-30	63.5	8	57.39	12	55.40	-
		6	55.52			
DMH-31	63.5	12	57.61	15	54.35	-
		12	54.37			

**Catch Basins**

Structure	Rim Elevation	Inlets		Outlets	
		Pipe Dia. (in.)	Elevation	Pipe Dia. (in.)	Elevation
CB-17	66.30	6	63	8	62.80
CB-18	61.88	6	58.25	12	58.05

**Piping**

Pipe	Pipe Dia (in.)	From	Elevation	To	Elevation	Length (ft)	Slope (ft/ft)
		Structure		Structure			
P38A	15	B3	55.43	DMH-34	54.77	33	0.020
P45	15	DMH-31	54.35	DMH-27	53.05	259	0.005
P46	12	DMH-30	55.4	DMH-31	54.37	206	0.005
P47	8	DMH-29	57.85	DMH-30	57.39	46	0.010
P48	8	ICS-28	58	DMH-29	57.9	10	0.010
P49	8	B6	59.2	ICS-28	58.85	71	0.005
P50	12	CB-17	58.05	DMH-26	57.78	27	0.010
P51	12	CB-18	58.05	DMH-26	57.82	23	0.010
P52	12	DMH-26	57.75	DMH-31	57.61	28	0.005



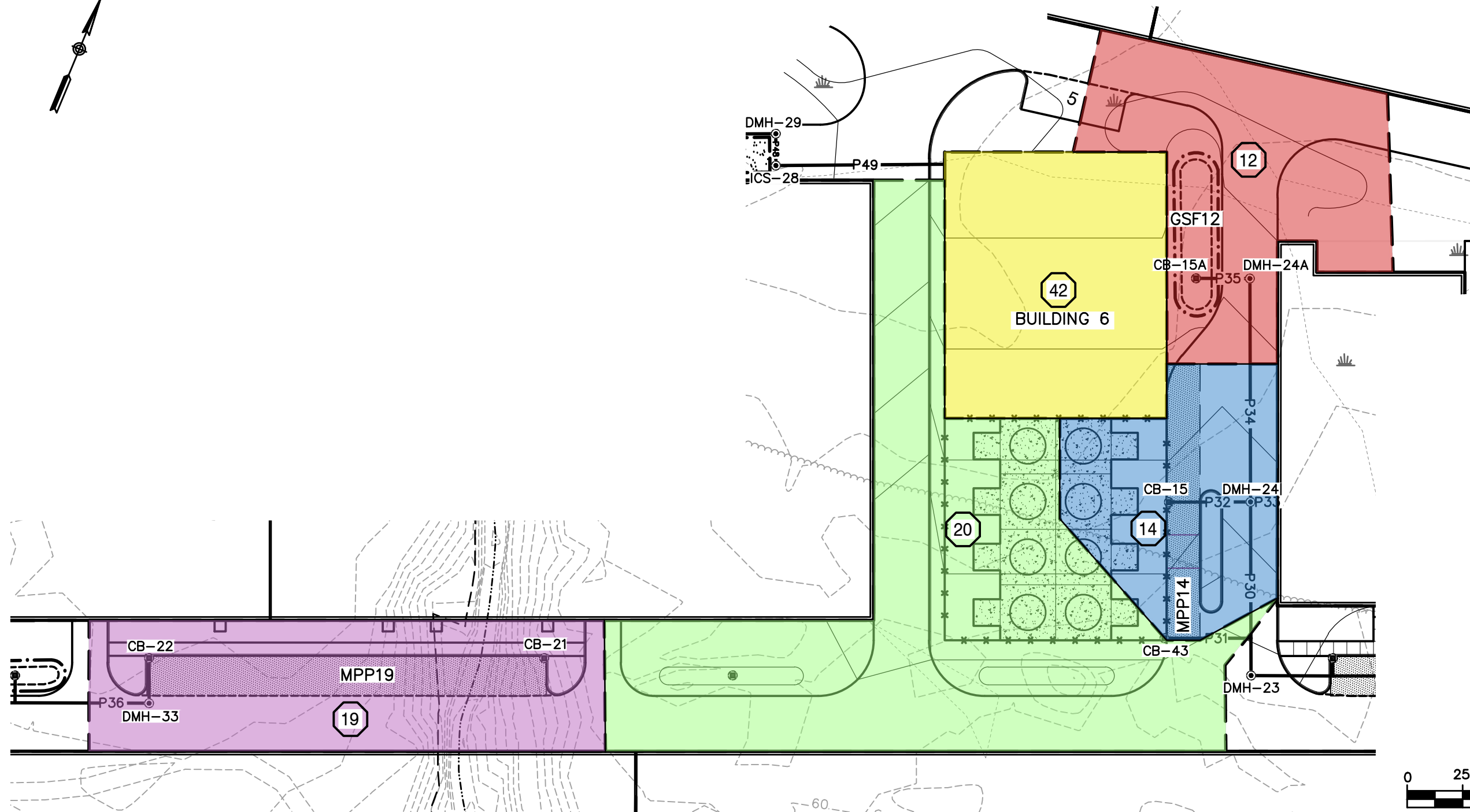

SCALE in FEET  
1"=50'

**RANSOM** Consulting Engineers  
and Scientists

PREPARED FOR:  
NORDIC AQUAFARMS  
158 HIGH STREET  
BELFAST, MAINE

SITE:  
NORDIC AQUAFARMS  
158 HIGH STREET  
BELFAST, MAINE

**SUBCATCHMENTS**  
**12, 14, 19,**  
**20 & 42**

DATE: MARCH 2019  
PROJECT: 171.05027  
FIGURE: 5

**Figure 5**

**Structures**

Structure	Rim Elevation	Inlets		Outlets		Weir Elevation
		Pipe Dia. (in.)	Elevation	Pipe Dia. (in.)	Elevation	
DMH-24	61.3	8	57.10	12	56.10	-
		8	57.69			
		8	56.12			
DMH-24A	63.3	8	58.10	8	58.00	-
DMH-33	59.5	6	55.00	12	54.00	-

**Catch Basins**

Structure	Rim Elevation	Inlets		Outlets	
		Pipe Dia. (in.)	Elevation	Pipe Dia. (in.)	Elevation
CB-15	61.90	-	-	6	56.47
CB-15A	61.90	6	58.25	8	58.20
CB-21	59.90	-	-	6	55.12
CB-22	58.90	-	-	6	55.12
CB-43	60.25	-	-	6	56.23

**Piping**

Pipe	Pipe Dia (in.)	From	Elevation	To	Elevation	Length (ft)	Slope (ft/ft)
		Structure		Structure			
P30	12	DMH-24	56.1	DMH-23	55.92	72	0.003
P31	6	CB-43	56.23	P30	56.13	21	0.005
P32	8	B4	57.75	DMH-24	57.69	12	0.005
P33	6	CB-15	56.23	DMH-24	56.12	21	0.005
P34	8	DMH-24A	58	DMH-24	57.1	95	0.009
P35	8	CB-15A	58.2	DMH-24A	58.1	21	0.005
P92	6	CB-22	55.12	DMH-33	55	19	0.006

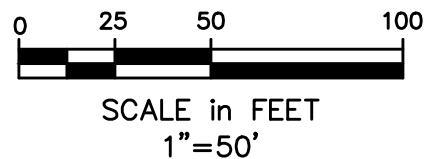
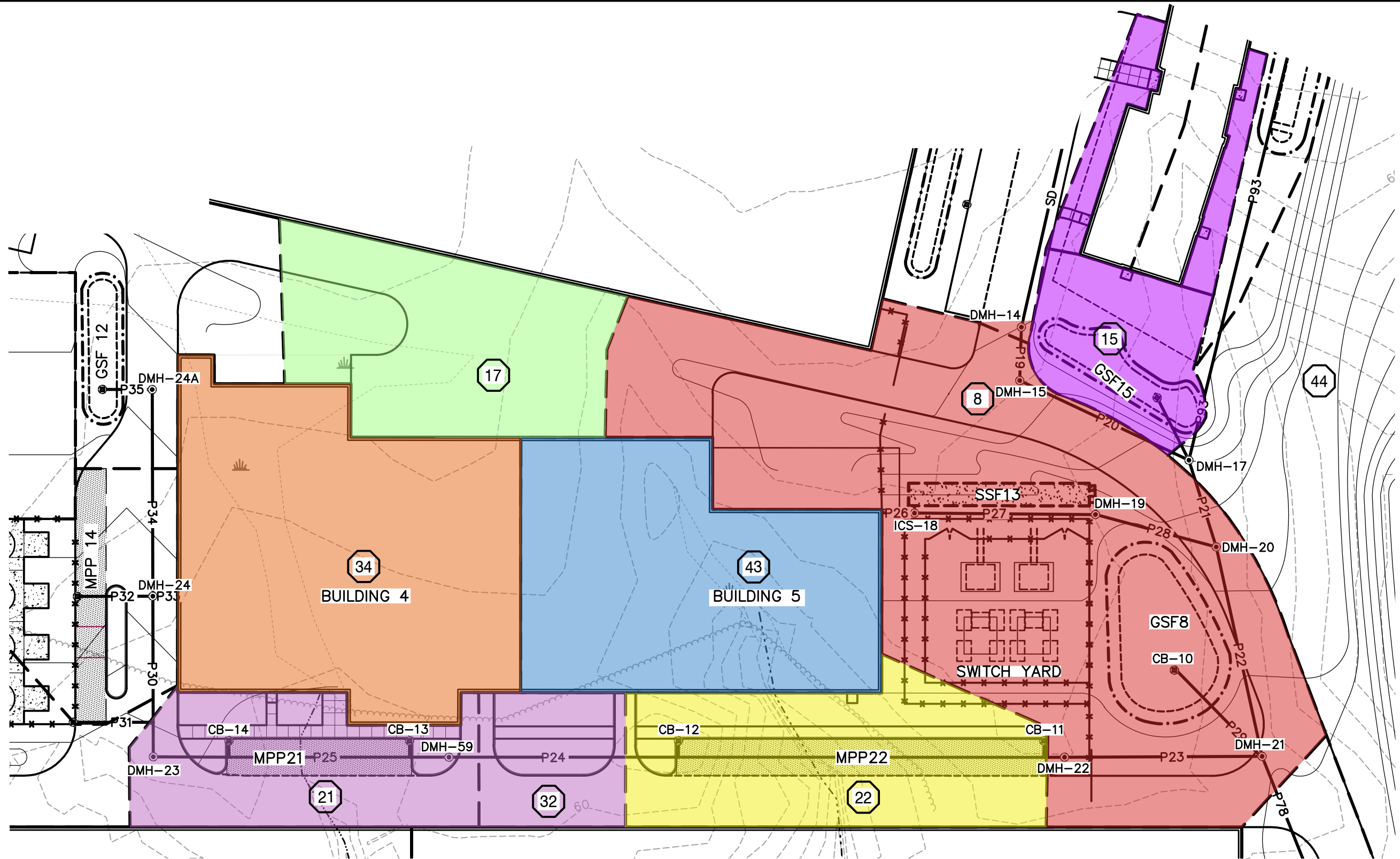
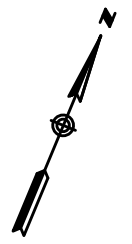

		<b>SUBCATCHMENTS</b> <b>8, 15, 17, 21,</b> <b>22, 34 &amp; 43</b>
PREPARED FOR: NORDIC AQUAFARMS 158 HIGH STREET BELFAST, MAINE	SITE: NORDIC AQUAFARMS 158 HIGH STREET BELFAST, MAINE	

**Figure 6****Structures**

Structure	Rim Elevation	Inlets		Outlets		Weir Elevation
		Pipe Dia. (in.)	Elevation	Pipe Dia. (in.)	Elevation	
DMH-14	65.8	30	52.09	30	52.07	-
DMH-15	64.33	30	51.95	30	51.95	-
DMH-17	63	8	60.52	30	51.48	-
		12	58.00			
		30	51.50			
ICS-18	62	12	57.82	8	57.81	60.25
				12	57.80	
DMH-19	61.5	12	56.97	12	54.48	-
		6	54.50			
DMH-20	61.5	12	53.89	30	51.28	-
		30	51.30			
DMH-21	58.55	12	52.93	36	50.76	-
		15	51.03			
		30	50.78			
DMH-22	59.5	12	52.83	15	51.50	-
DMH-23	59.5	12	55.92	12	55.19	-
DMH -59	59.75	12	54.50	12	54.30	-

**Catch Basins**

Structure	Rim Elevation	Inlets		Outlets	
		Pipe Dia. (in.)	Elevation	Pipe Dia. (in.)	Elevation
CB-9	63.70	6	60.75	8	60.70
CB-10	57.60	6	53.75	8	53.50
CB-11	58.82	-	-	6	55.05
CB-12	58.82	-	-	6	55.05
CB-13	58.90	-	-	6	54.73
CB-14	58.80	-	-	6	54.73

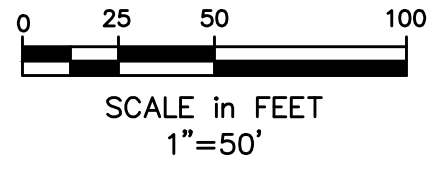
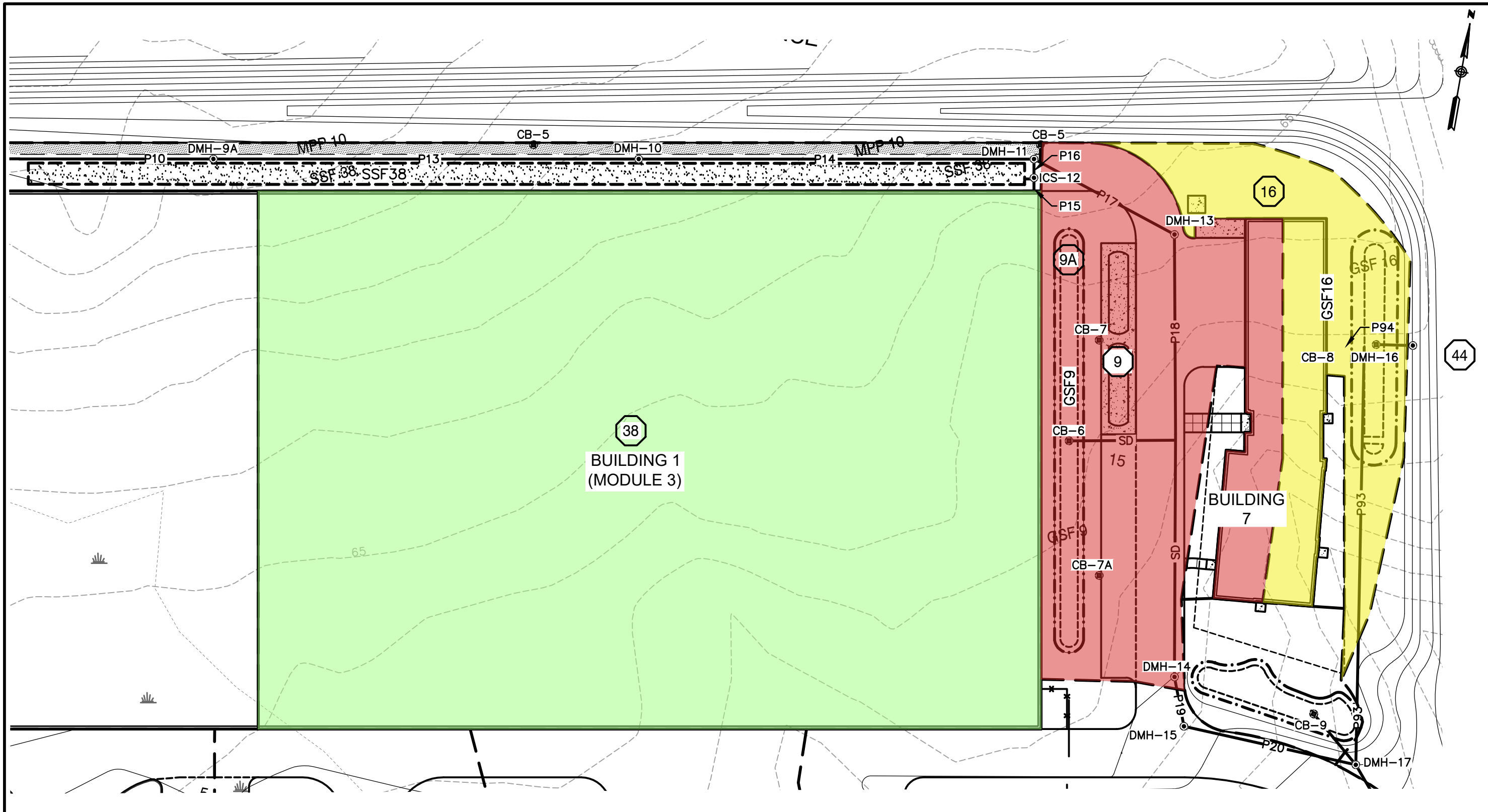

		<b>SUBCATCHMENTS 9, 16 &amp; 38</b>
PREPARED FOR: NORDIC AQUAFARMS 158 HIGH STREET BELFAST, MAINE	SITE: NORDIC AQUAFARMS 158 HIGH STREET BELFAST, MAINE	

**Figure 7**

**Structures**

Structure	Rim Elevation	Inlets		Outlets		Weir Elevation
		Pipe Dia. (in.)	Elevation	Pipe Dia. (in.)	Elevation	
DMH-9A	65.74	6	57.37	24	55.64	-
		24	55.66			
DMH-10	65.54	6	57.37	24	54.59	-
		24	54.61			
DMH-11	65.56	18	60.15	30	53.54	-
		24	53.56			
ICS-12	65.42	18	60.95	12	60.75	62.95
				18	60.70	
DMH-13	65.8	30	53.12	30	53.10	-
DMH-16	64	8	60.54	12	60.50	-

**Catch Basins**

Structure	Rim Elevation	Inlets		Outlets	
		Pipe Dia. (in.)	Elevation	Pipe Dia. (in.)	Elevation
CB-4A	65.52	-	-	6	61.48
CB-5	65.40	-	-	6	61.48
CB-6	63.00	6	59.25	8	59.00
CB-7 (rain guardian)	65.07	-	-	-	64.19
CB-7A (rain guardian)	65.07	-	-	-	64.19
CB-8	64.40	6	60.75	8	60.70

**Piping**

Pipe	Pipe Dia (in.)	From	Elevation	To	Elevation	Length (ft)	Slope (ft/ft)
		Structure		Structure			
P13	24	DMH-9A	55.64	DMH-10	54.61	206	0.005
P14	24	DMH-10	54.59	DMH-11	53.56	206	0.005
P15	18	B1M3	60.97	ICS-12	60.95	4	0.005
P16	18	ICS-12	60.7	DMH-11	60.66	4	0.010
P17	30	DMH-11	53.54	DMH-13	53.12	84	0.005
P18	30	DMH-13	53.1	DMH-14	52.09	201	0.005
P93	12	DMH-16	60.5	DMH-17	58	198	0.013
P94	8	CB-8	60.7	DMH-16	60.54	16	0.010
P95	8	CB-6	0	P18	0	16	0.010

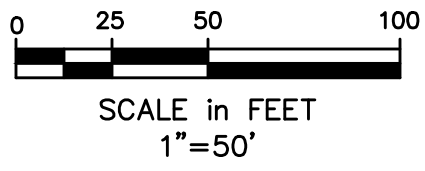
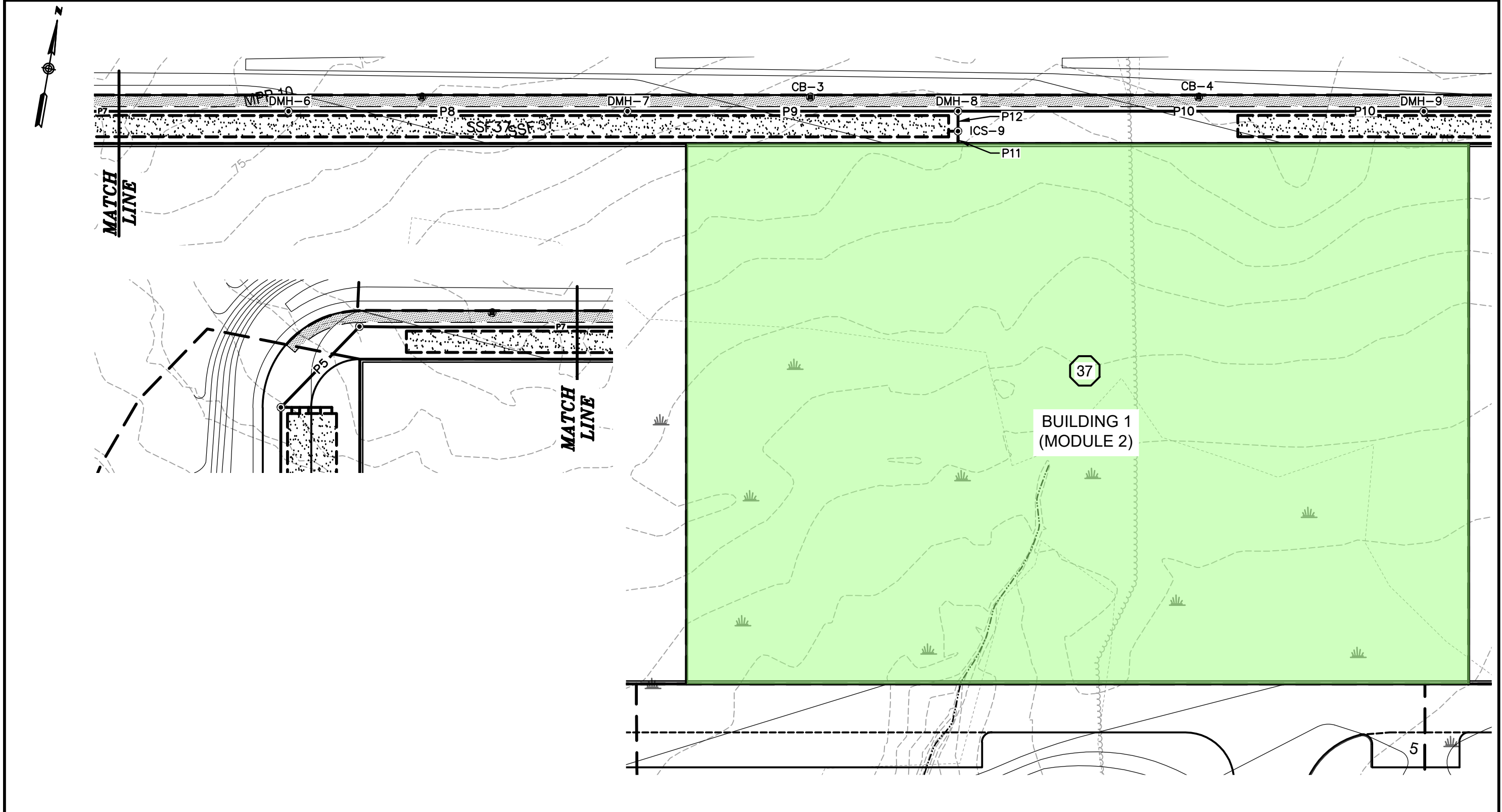

		<b>SUBCATCHMENT 37</b>	
		PREPARED FOR: NORDIC AQUAFARMS 158 HIGH STREET BELFAST, MAINE	SITE: NORDIC AQUAFARMS 158 HIGH STREET BELFAST, MAINE

**Figure 8****Structures**

Structure	Rim Elevation	Inlets		Outlets		Weir Elevation
		Pipe Dia. (in.)	Elevation	Pipe Dia. (in.)	Elevation	
DMH-5	69.04	18	59.57	18	59.48	-
DMH-6	68.33	6	58.60	18	58.58	-
		18	58.61			
DMH-7	67.5	6	58.60	18	57.71	-
		18	57.73			
DMH-8	66.6	18	61.00	24	56.84	-
		18	56.86			
ICS-9	66.76	18	62.15	12	62.00	64.18
				18	61.70	

**Piping**

Pipe	Pipe Dia (in.)	From	Elevation	To	Elevation	Length (ft)	Slope (ft/ft)
		Structure		Structure			
P7	18	DMH-5	59.48	DMH-6	58.61	173	0.005
P8	18	DMH-6	58.58	DMH-7	57.73	170	0.005
P9	18	DMH-7	57.71	DMH-8	56.86	170	0.005
P10	24	DMH-8	56.84	DMH-9A	55.66	236	0.005
P11	18	B1M2	62.17	ICS-9	62.15	4	0.005
P12	18	ICS-9	61.7	DMH-8	61	14	0.050



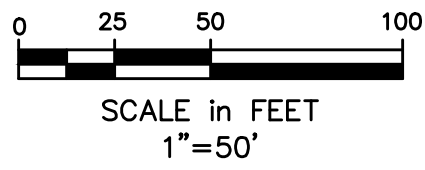
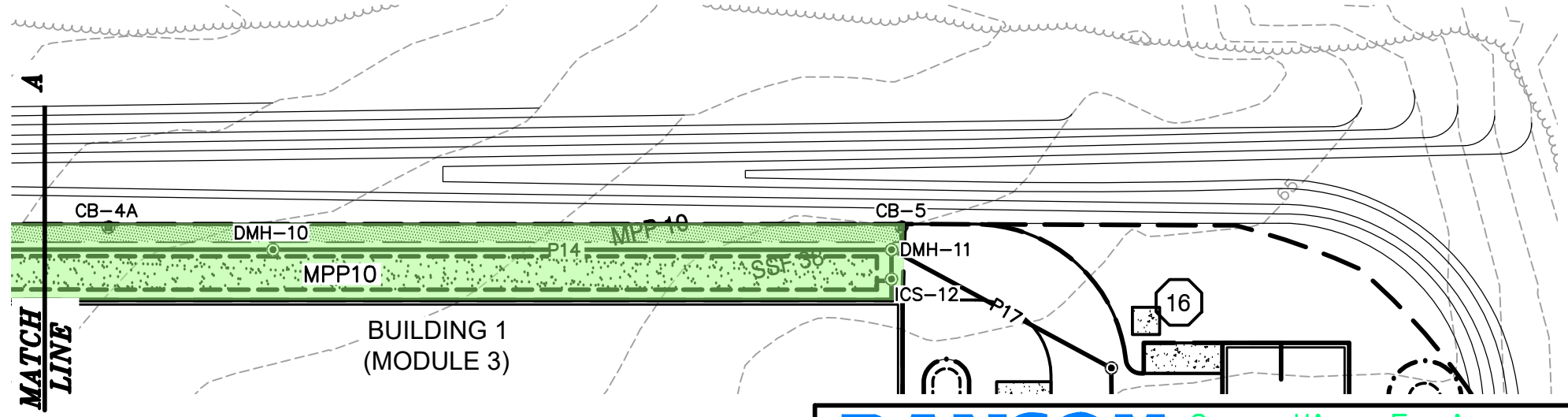
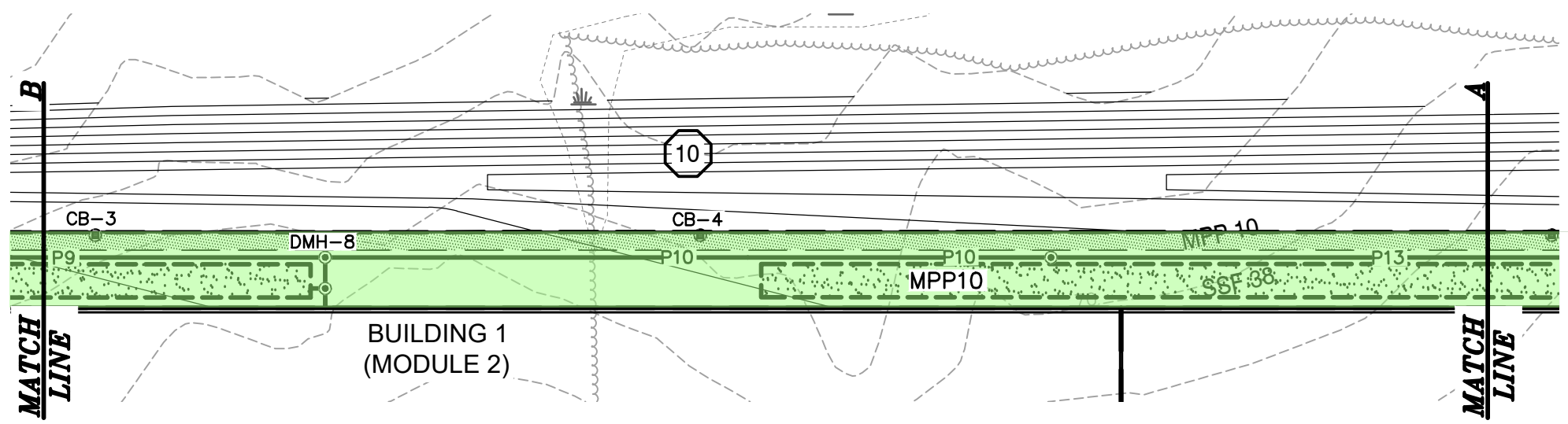
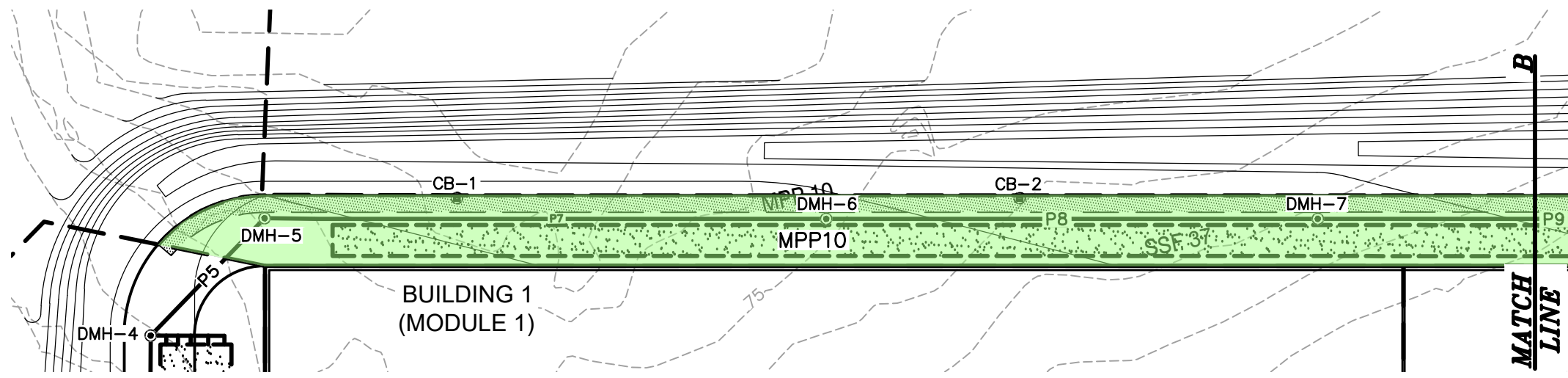

**RANSOM** Consulting Engineers and Scientists

PREPARED FOR:  
 NORDIC AQUAFARMS  
 158 HIGH STREET  
 BELFAST, MAINE

SITE:  
 NORDIC AQUAFARMS  
 158 HIGH STREET  
 BELFAST, MAINE

<b>SUBCATCHMENT 10</b>	
DATE:	MARCH 2019
PROJECT:	171.05027
FIGURE:	9

**Figure 9**

**Structures**

Structure	Rim Elevation	Inlets		Outlets		Weir Elevation
		Pipe Dia. (in.)	Elevation	Pipe Dia. (in.)	Elevation	
DMH-5	69.04	18	59.57	18	59.48	-
DMH-6	68.33	6	58.60	18	58.58	-
		18	58.61			
DMH-7	67.5	6	58.60	18	57.71	-
		18	57.73			
DMH-8	66.6	18	61.00	24	56.84	-
		18	56.86			
ICS-9	66.76	18	62.15	12	62.00	64.18
				18	61.70	
DMH-9A	65.74	6	57.37	24	55.64	-
		24	55.66			
DMH-10	65.54	6	57.37	24	54.59	-
		24	54.61			
DMH-11	65.56	18	60.15	30	53.54	-
		24	53.56			
ICS-12	65.42	18	60.95	12	60.75	62.95
				18	60.70	

**Catch Basins**

Structure	Rim Elevation	Inlets		Outlets	
		Pipe Dia. (in.)	Elevation	Pipe Dia. (in.)	Elevation
CB-1	68.82	-	-	6	61.48
CB-2	67.85	-	-	6	61.48
CB-3	66.87	-	-	6	61.48
CB-4	65.74	-	-	6	61.48
CB-4A	65.52	-	-	6	61.48
CB-5	65.40	-	-	6	61.48

**Piping**

Pipe	Pipe Dia (in.)	From	Elevation	To	Elevation	Length (ft)	Slope (ft/ft)
		Structure		Structure			
P7	18	DMH-5	59.48	DMH-6	58.61	173	0.005028902
P8	18	DMH-6	58.58	DMH-7	57.73	170	0.005
P9	18	DMH-7	57.71	DMH-8	56.86	170	0.005
P10	24	DMH-8	56.84	DMH-9A	55.66	236	0.005
P11	18	B1M2	62.17	ICS-9	62.15	4	0.005
P12	18	ICS-9	61.7	DMH-8	61	14	0.05
P13	24	DMH-9A	55.64	DMH-10	54.61	206	0.005
P14	24	DMH-10	54.59	DMH-11	53.56	206	0.005
P15	18	B1M3	60.97	ICS-12	60.95	4	0.005
P16	18	ICS-12	60.7	DMH-11	60.66	4	0.01

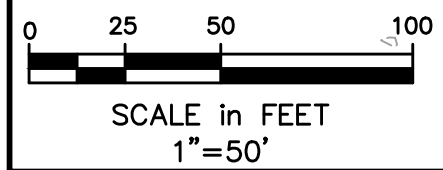
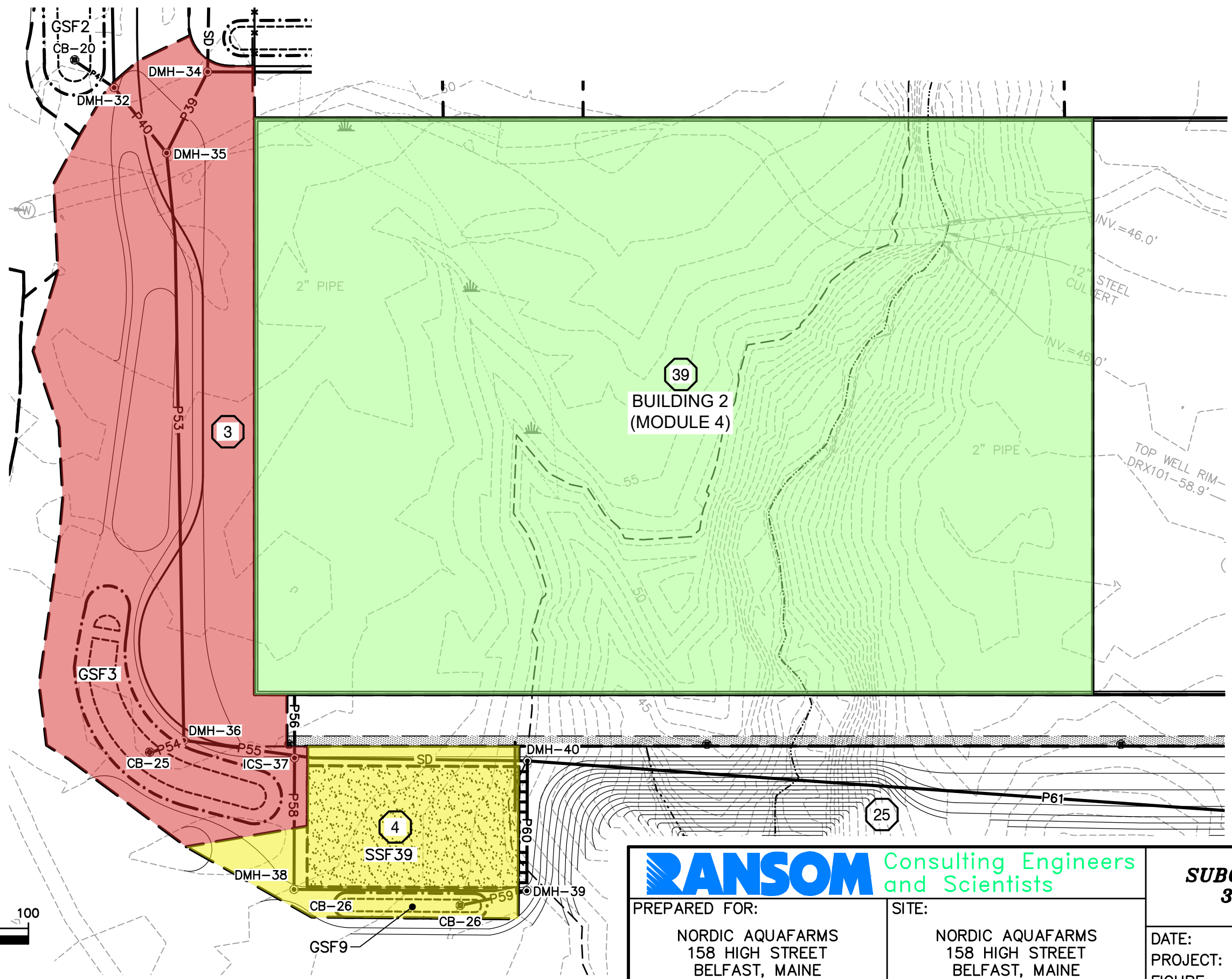
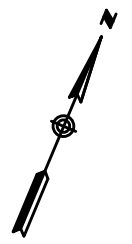

**RANSOM** Consulting Engineers and Scientists

PREPARED FOR:  
 NORDIC AQUAFARMS  
 158 HIGH STREET  
 BELFAST, MAINE

SITE:  
 NORDIC AQUAFARMS  
 158 HIGH STREET  
 BELFAST, MAINE

**SUBCATCHMENTS  
 3, 4 & 39**

DATE: MARCH 2019  
 PROJECT: 171.05027  
 FIGURE: 10

**Figure 10**

**Structures**

Structure	Rim Elevation	Inlets		Outlets		Weir Elevation
		Pipe Dia. (in.)	Elevation	Pipe Dia. (in.)	Elevation	
DMH-32	58.5	8	53.76	18	51.73	-
		15	51.75			
DMH-34	59.5	12	52.01	18	51.99	-
		15	54.77			
DMH-35	58.5	18	51.60	24	51.55	-
		18	51.57			
DMH-36	53.8	12	51.84	24	50.15	-
		24	50.17			
ICS-37	57	18	53.50	12	52.80	55.00
				18	52.50	
DMH-38	56.5	18	52.00	18	51.98	-
DMH-39	56.5	8	51.56	18	50.90	-
		18	50.92			
DMH-40	57	18	50.32	30	49.33	-
		24	49.35			

**Catch Basins**

Structure	Rim Elevation	Inlets		Outlets	
		Pipe Dia. (in.)	Elevation	Pipe Dia. (in.)	Elevation
CB-25	55.75	6	52	12	51.98
CB-26	55.10	6	51.75	8	51.73

**Piping**

Pipe	Pipe Dia (in.)	From	Elevation	To	Elevation	Length (ft)	Slope (ft/ft)
		Structure		Structure			
P39	18	DMH-34	51.99	DMH-35	51.6	39	0.010
P40	18	DMH-32	51.73	DMH-35	51.57	36	0.004
P53	24	DMH-35	51.55	DMH-36	50.17	276	0.005
P54	12	CB-25	51.98	DMH-36	51.84	14	0.010
P55	24	DMH-36	50.15	DMH-40	49.35	159	0.005
P56	18	B2M4	53.16	ICS-37	52.5	33	0.020
P57	6	CB-26	51.73	DMH-39	51.56	17	0.010
P58	18	ICS-37	52.5	DMH-38	52	51	0.010
P59	18	DMH-38	51.98	DMH-39	50.92	106	0.010
P60	18	DMH-39	50.9	DMH-40	50.32	58	0.010
P61	30	DMH-40	49.33	DMH-43	47.63	340	0.005

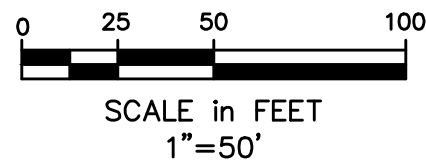
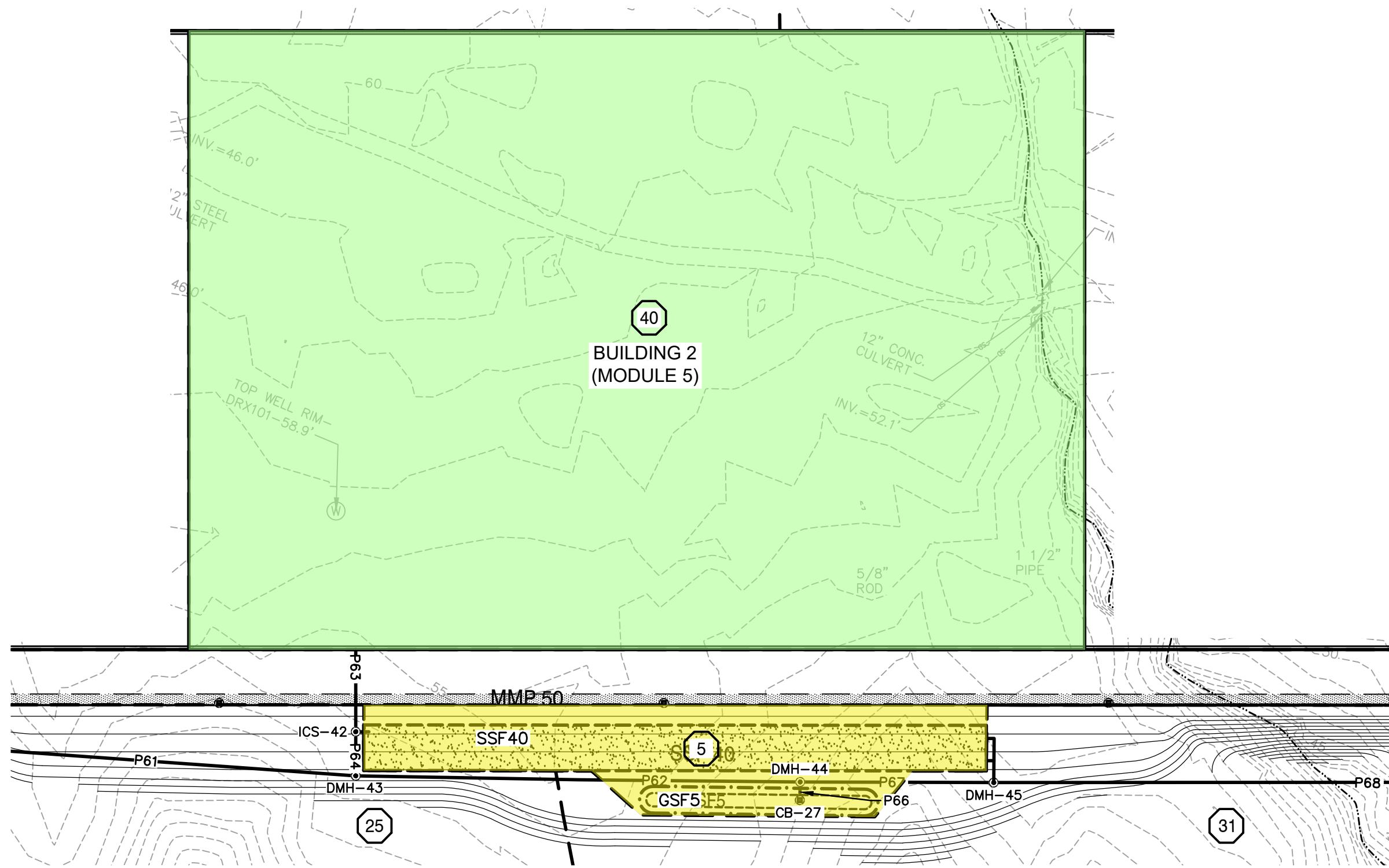
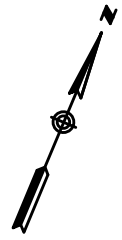

		<b>SUBCATCHMENTS 5 &amp; 40</b>	
		PREPARED FOR: NORDIC AQUAFARMS 158 HIGH STREET BELFAST, MAINE	SITE: NORDIC AQUAFARMS 158 HIGH STREET BELFAST, MAINE

**Figure 11**

**Structures**

Structure	Rim Elevation	Inlets		Outlets		Weir Elevation
		Pipe Dia. (in.)	Elevation	Pipe Dia. (in.)	Elevation	
ICS-42	57	18	53.50	12	52.80	55.37
				18	52.20	
DMH-43	56.5	18	52.48	30	47.61	-
		30	47.63			
DMH-44	56	8	50.95	36	46.62	-
		6	49.42			
		30	46.64			
DMH-45	56	6	49.42	30	46.19	-
		30	46.21			

**Catch Basins**

Structure	Rim Elevation	Inlets		Outlets	
		Pipe Dia. (in.)	Elevation	Pipe Dia. (in.)	Elevation
CB-27	54.60	6	51.25	8	51.00

**Piping**

Pipe	Pipe Dia (in.)	From	Elevation	To	Elevation	Length (ft)	Slope (ft/ft)
		Structure		Structure			
P61	30	DMH-40	49.33	DMH-43	47.63	340	0.005
P62	30	DMH-43	47.61	DMH-44	46.64	193	0.005025907
P63	18	B2M5	54.2	ICS-42	53.5	35	0.02
P64	18	ICS-42	52.2	DMH-43	51.88	16	0.02
P66	8	CB-27	51	DMH-44	50.95	5	0.01
P67	36	DMH-44	46.62	DMH-45	46.21	82	0.005
P68	36	DMH-45	46.19	DMH-47	44.61	316	0.005

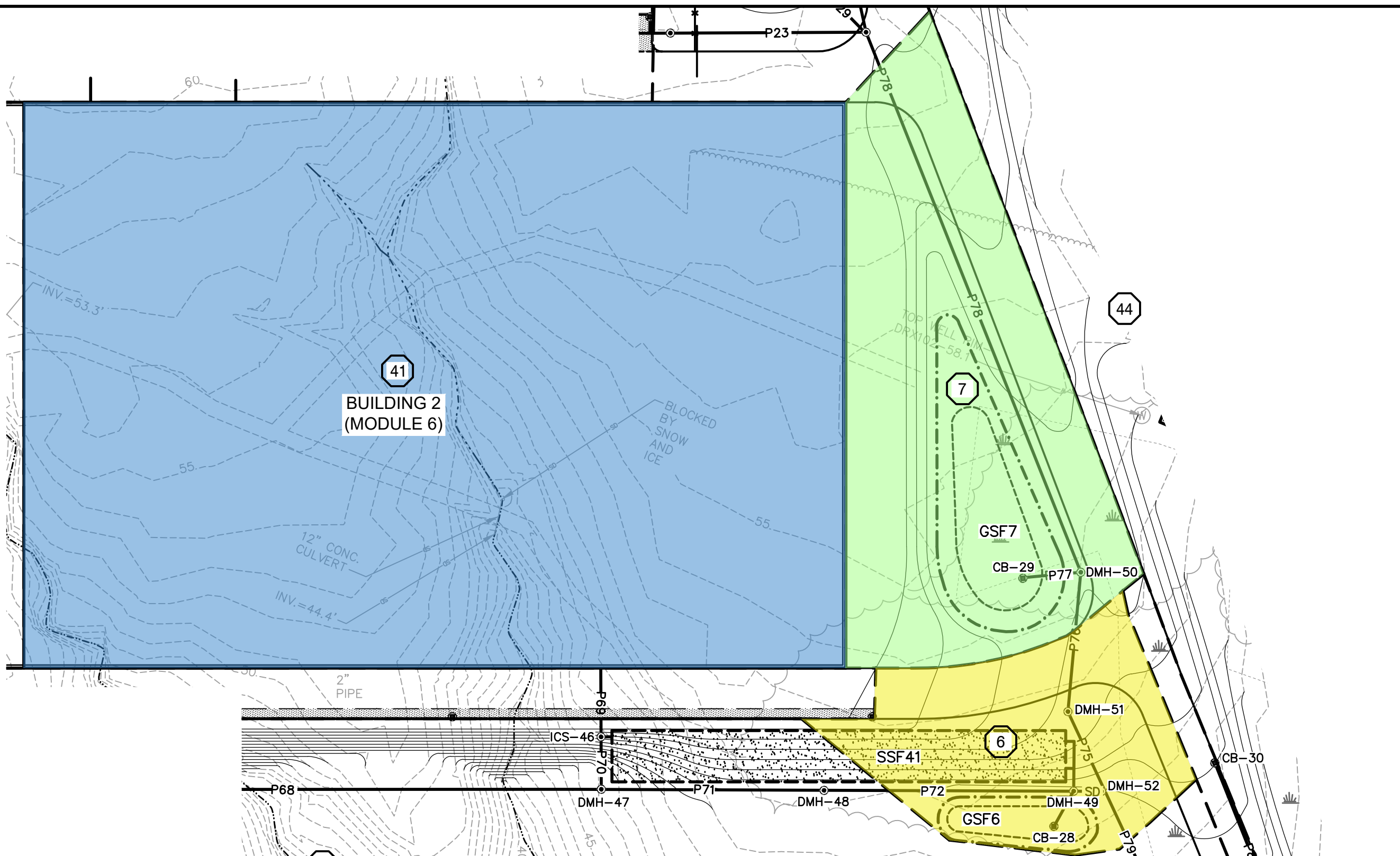
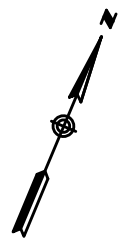

31

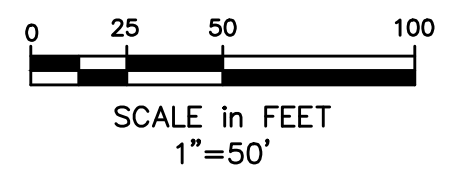

**RANSOM** Consulting Engineers and Scientists

PREPARED FOR:  
 NORDIC AQUAFARMS  
 158 HIGH STREET  
 BELFAST, MAINE

SITE:  
 NORDIC AQUAFARMS  
 158 HIGH STREET  
 BELFAST, MAINE

**SUBCATCHMENTS  
 6, 7 & 41**

DATE: MARCH 2019  
 PROJECT: 171.05027  
 FIGURE: 12

**Figure 12**

**Structures**

Structure	Rim Elevation	Inlets		Outlets		Weir Elevation
		Pipe Dia. (in.)	Elevation	Pipe Dia. (in.)	Elevation	
ICS-46	55.5	18	47.50	12 18	46.80 46.20	49.00
DMH-47	55.5	18 36	46.00 44.61	36	44.00	-
DMH-48	50.5	6 36	43.42 42.96	36	42.94	-
DMH-49	50.5	6 36 8	43.42 42.35 44.53	36	42.33	-
DMH-50	56	36 8	46.00 50.48	36	44.75	-
DMH-51	55.5	36	44.11	36	44.09	-
DMH-52	50	36 36	42.23 43.00	60	41.00	-

**Catch Basins**

Structure	Rim Elevation	Inlets		Outlets	
		Pipe Dia. (in.)	Elevation	Pipe Dia. (in.)	Elevation
CB-28	48.2	6	44.65	8	44.7
CB-29	54.70	6	51.25	8	51.00

**Piping**

Pipe	Pipe Dia (in.)	From	Elevation	To	Elevation	Length (ft)	Slope (ft/ft)
		Structure		Structure			
P68	36	DMH-45	46.19	DMH-47	44.61	316	0.005
P69	18	B2M6	48.5	ICS-46	47.5	30	0.033
P70	18	ICS-46	46.2	DMH-47	46	22	0.009
P71	36	DMH-47	44	DMH-48	42.96	104	0.010
P72	36	DMH-48	42.94	DMH-49	42.35	117	0.005
P73	8	CB-28	47	DMH-49	46.83	17	0.010
P74	36	DMH-49	42.33	DMH-52	42.26	14	0.005
P75	36	DMH-51	44.09	DMH-52	43	38	0.029
P76	36	DMH-50	44.75	DMH-51	44.11	64	0.010
P77	8	CB-29	51	DMH-50	50.48	26	0.020
P78	36	DMH-21	50.76	DMH-50	46	281	0.017



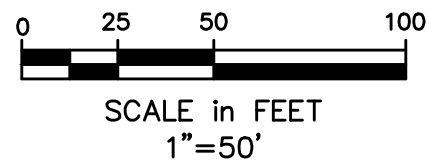
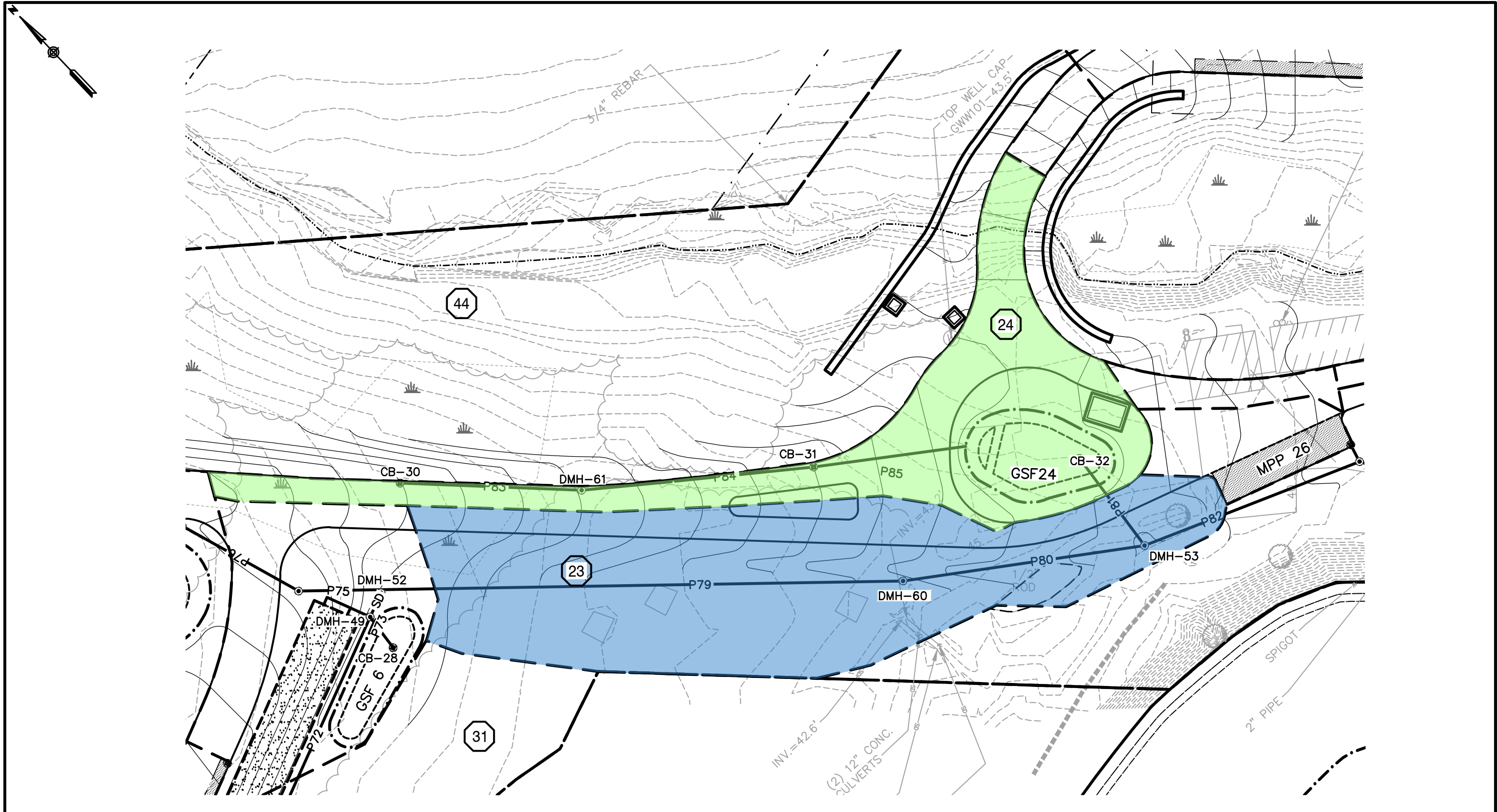

		<b>SUBCATCHMENTS 23 &amp; 24</b>
PREPARED FOR: NORDIC AQUAFARMS 158 HIGH STREET BELFAST, MAINE	SITE: NORDIC AQUAFARMS 158 HIGH STREET BELFAST, MAINE	

**Figure 13**

**Structures**

Structure	Rim Elevation	Inlets		Outlets		Weir Elevation
		Pipe Dia. (in.)	Elevation	Pipe Dia. (in.)	Elevation	
DMH-53	41.5	60	33.50	60	33.00	-
		8	36.00			
OCS-57	50	12	29.00	12	29.00	30.07
DMH-60	44	48	36.00	48	35.50	0

**Catch Basins**

Structure	Rim Elevation	Inlets		Outlets	
		Pipe Dia. (in.)	Elevation	Pipe Dia. (in.)	Elevation
CB-30	53	-	-	12	48
CB-31	46	12	41.5	12	40.8
CB-32	40.60	6	37	8	36.80

**Piping**

Pipe	Pipe Dia (in.)	From	Elevation	To	Elevation	Length (ft)	Slope (ft/ft)
		Structure		Structure			
P79	60	DMH-52	41	DMH-60	36	258	0.019
P80	60	DMH-60	35.5	DMH-53	33.5	114	0.018
P81	8	CB-32	36.8	DMH-53	36	40	0.020
P82	60	DMH-53	33	DMH-54	30.5	120	0.021
P83	12	CB-30	48	DMH-57	45.8	87	0.025
P84	12	DMH-57	44.4	CB-31	41.5	114	0.025
P85	12	CB-31	40.8	GSF 24	39.24	78	0.020

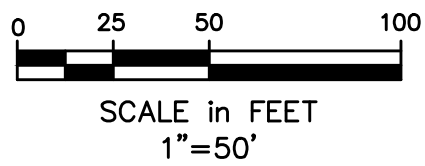
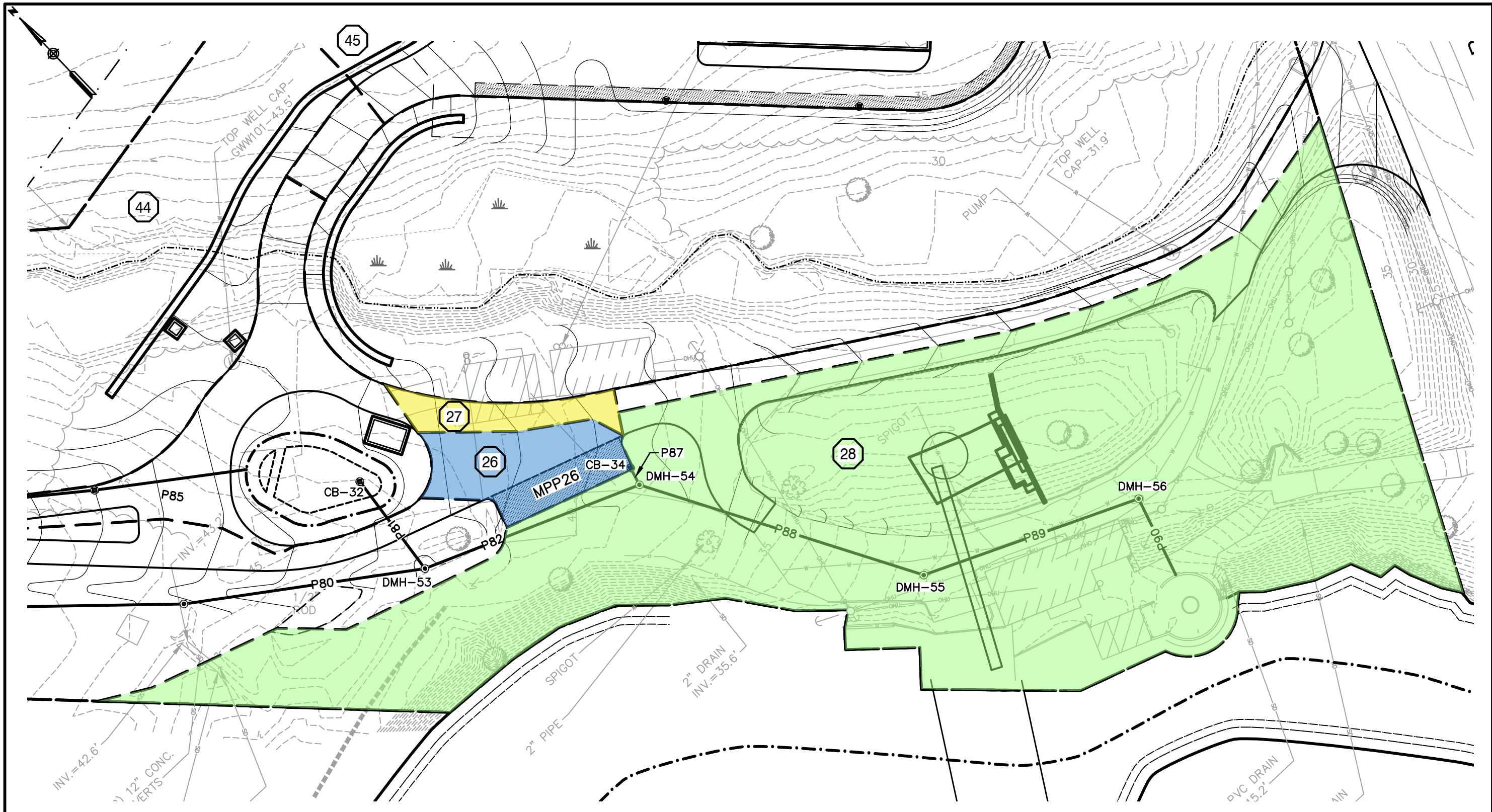

		<b>SUBCATCHMENTS 26, 27 &amp; 28</b>	
		PREPARED FOR: NORDIC AQUAFARMS 158 HIGH STREET BELFAST, MAINE	SITE: NORDIC AQUAFARMS 158 HIGH STREET BELFAST, MAINE

**Figure 14**

**Structures**

Structure	Rim Elevation	Inlets		Outlets		Weir Elevation
		Pipe Dia. (in.)	Elevation	Pipe Dia. (in.)	Elevation	
DMH-54	38.5	8	34.34	60	27.00	-
		60	30.50			
DMH-55	30	60	22.00	60	19.00	-
DMH-56	30	60	15.50	60	12.50	-

**Catch Basins**

Structure	Rim Elevation	Inlets		Outlets	
		Pipe Dia. (in.)	Elevation	Pipe Dia. (in.)	Elevation
CB-34	38.29	6	34.62	8	34.50

**Piping**

Pipe	Pipe Dia (in.)	From	Elevation	To	Elevation	Length (ft)	Slope (ft/ft)
		Structure		Structure			
P82	60	DMH-53	33	DMH-54	30.5	120	0.021
P87	18	CB-34	34.5	DMH-54	34.34	8	0.020
P88	60	DMH-54	27	DMH-55	22	152	0.033
P89	60	DMH-55	19	DMH-56	15.5	115	0.030
P90	60	DMH-56	12.5	CLARIFIER	11	42	0.036

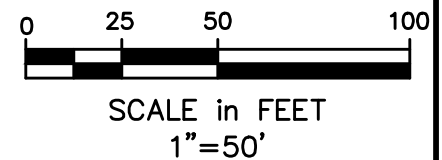
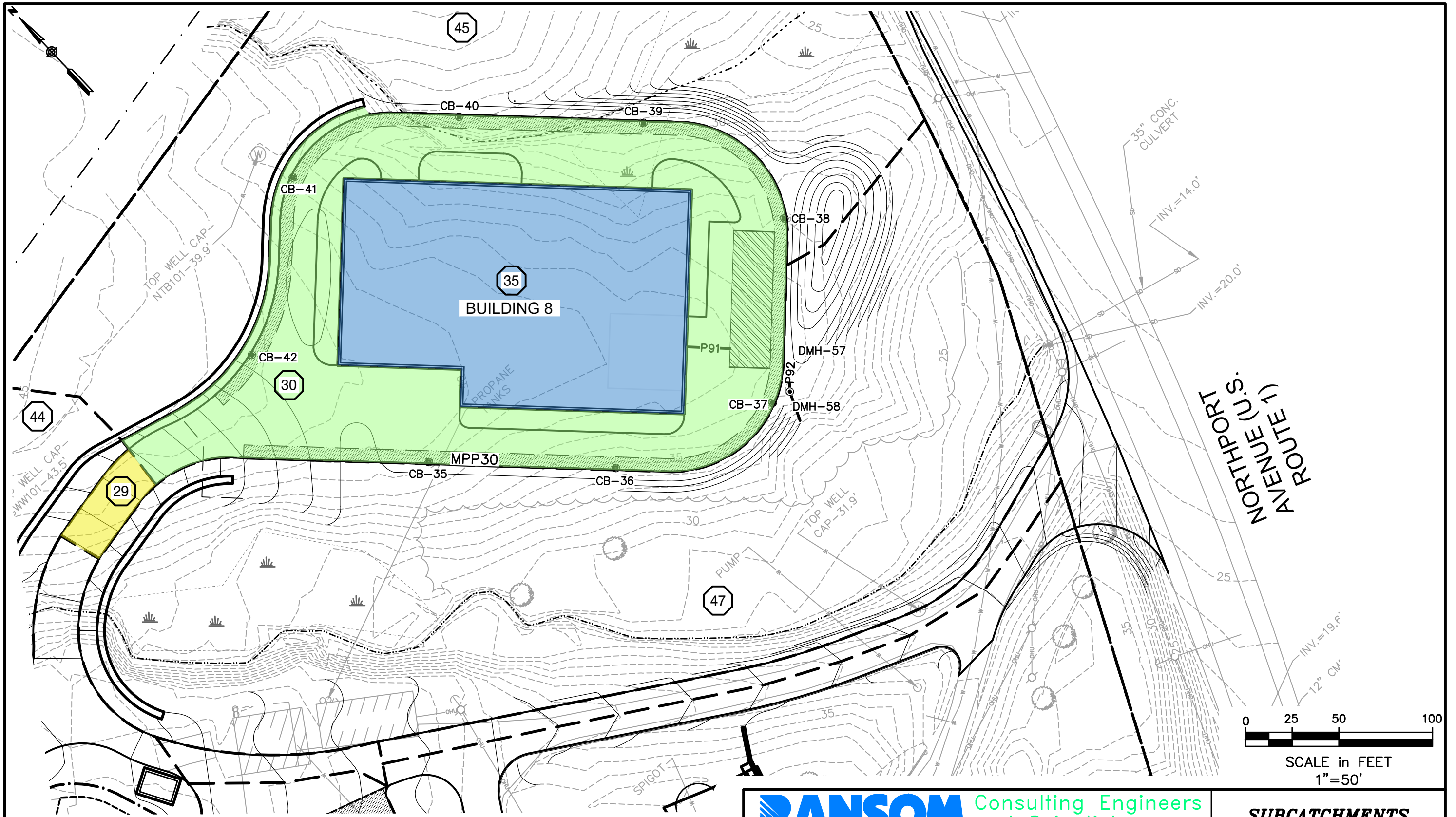

		<b>SUBCATCHMENTS 29, 30 &amp; 35</b>	
		PREPARED FOR: NORDIC AQUAFARMS 158 HIGH STREET BELFAST, MAINE	SITE: NORDIC AQUAFARMS 158 HIGH STREET BELFAST, MAINE

**Figure 15**

**Structures**

Structure	Rim Elevation	Inlets		Outlets		Weir Elevation
		Pipe Dia. (in.)	Elevation	Pipe Dia. (in.)	Elevation	
OCS-57	50	12	29.00	12	29.00	30.07

**Catch Basins**

Structure	Rim Elevation	Inlets		Outlets	
		Pipe Dia. (in.)	Elevation	Pipe Dia. (in.)	Elevation
CB-35	35.40	-	-	6	30.98
CB-36	35.50	-	-	6	30.98
CB-37	35.00	-	-	6	30.98
CB-38	35.00	-	-	6	30.98
CB-39	35.30	-	-	6	30.98
CB-40	35.40	-	-	6	30.98
CB-41	35.45	-	-	6	30.98
CB-42	35.50	-	-	6	30.98

**Piping**

Pipe	Pipe Dia (in.)	From	Elevation	To	Elevation	Length (ft)	Slope (ft/ft)
		Structure		Structure			
P91	12	B8	29.76	R-TANK	29.5	13	0.02

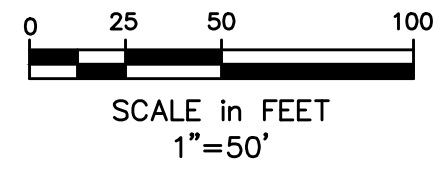
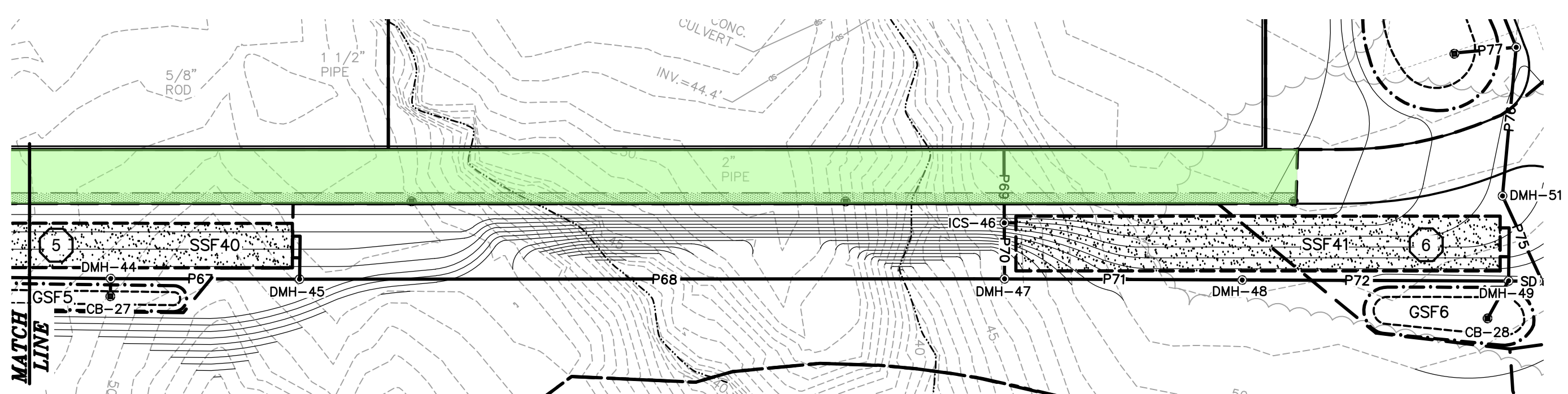
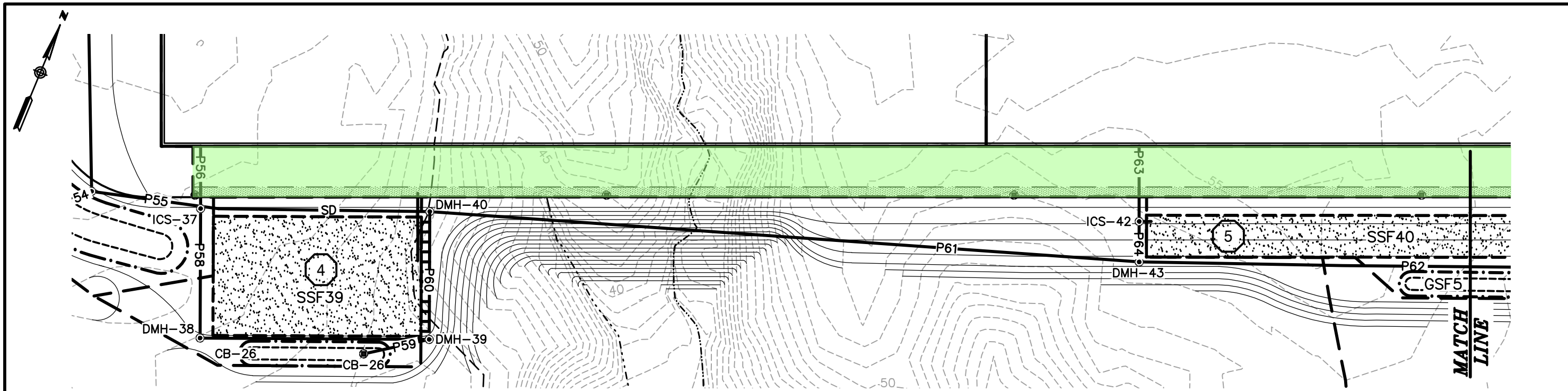

		<b>SUBCATCHMENT 50</b>	
		PREPARED FOR: NORDIC AQUAFARMS 158 HIGH STREET BELFAST, MAINE	SITE: NORDIC AQUAFARMS 158 HIGH STREET BELFAST, MAINE

**Figure 16**

**Catch Basins**

Structure	Rim Elevation	Inlets		Outlets	
		Pipe Dia. (in.)	Elevation	Pipe Dia. (in.)	Elevation
CB-44	59.00	-	-	6	54.58
CB-45	59.00	-	-	6	54.58
CB-46	59.00	-	-	6	54.58
CB-47	59.00	-	-	6	54.58
CB-48	59.00	-	-	6	54.58
CB-49	59.00	-	-	6	54.58
CB-50	58.65	-	-	6	54.58