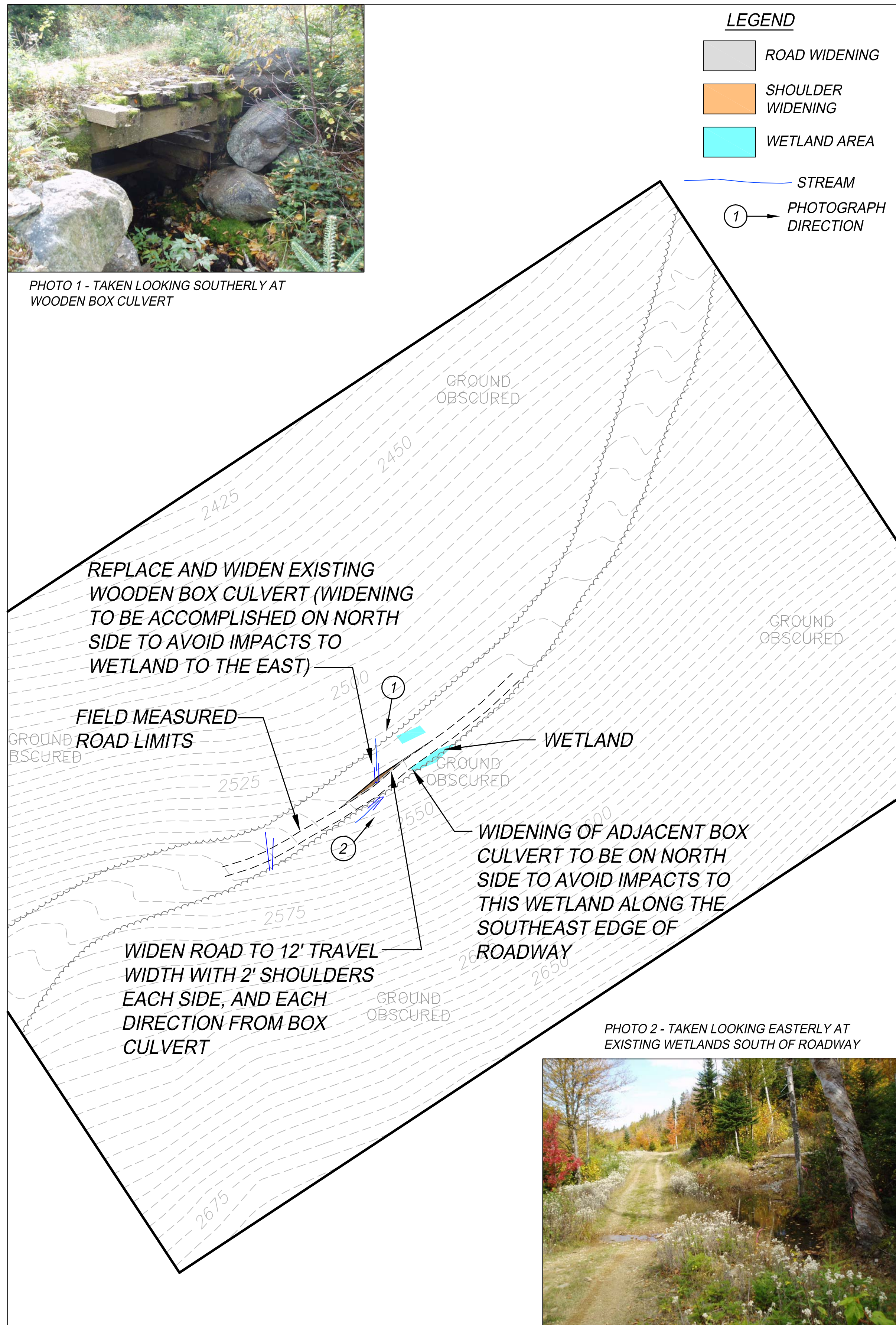



PHOTO 1 - TAKEN LOOKING SOUTHERLY AT WOODEN BOX CULVERT



EXISTING ROAD IMPROVEMENTS INSET AREA 4

1" = 100'

PHOTO 2 - TAKEN LOOKING EASTERLY AT EXISTING WETLANDS SOUTH OF ROADWAY



PHOTO 1 - TAKEN LOOKING NORTHEASTERLY AT EXISTING STREAM CROSSING

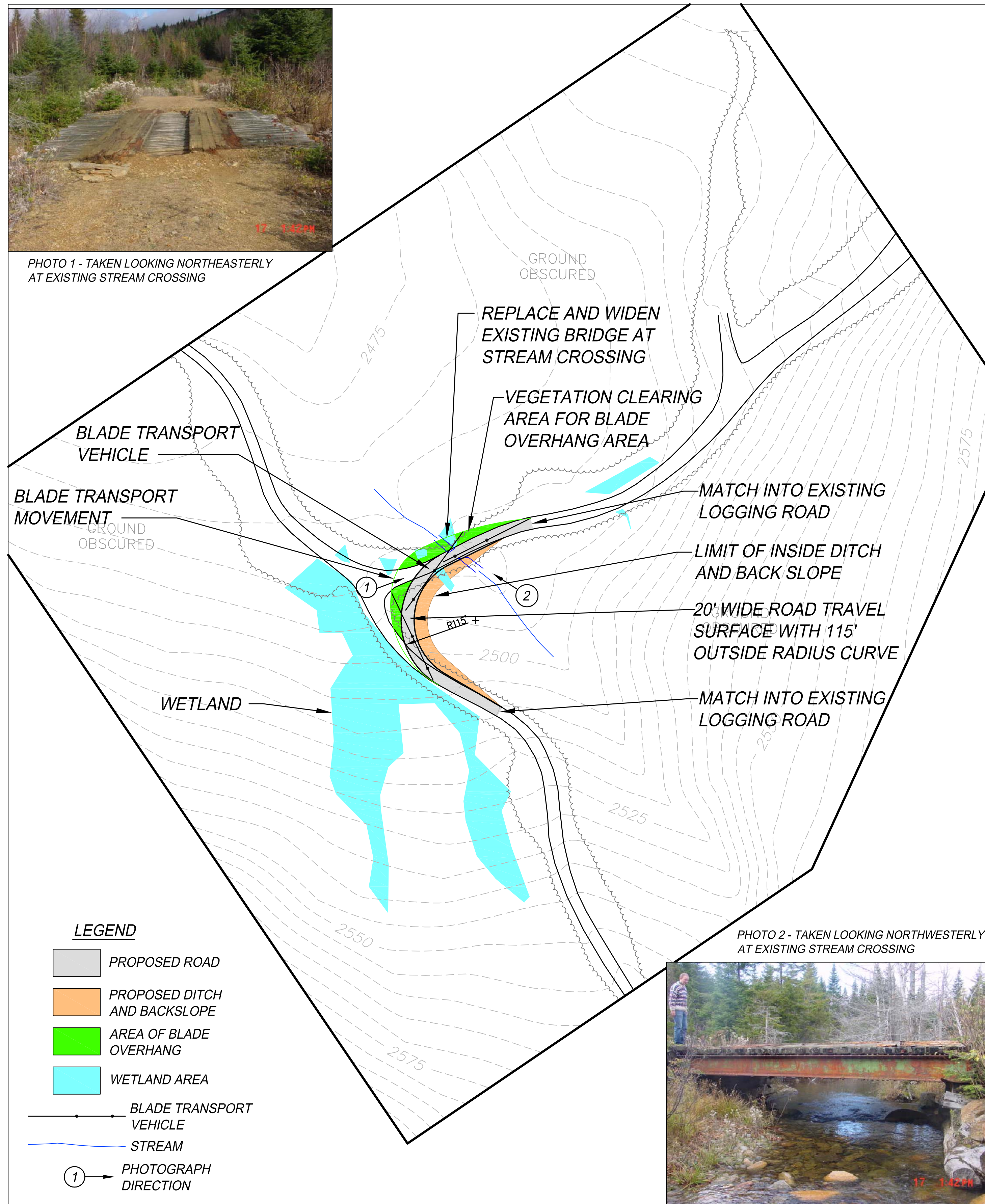

EXISTING ROAD IMPROVEMENTS INSET AREA 5

1" = 100'

PHOTO 2 - TAKEN LOOKING NORTHWESTERLY AT EXISTING STREAM CROSSING

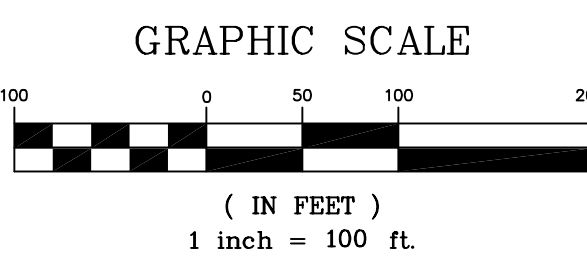

NOTES:

1. RESOURCE BOUNDARIES AS ILLUSTRATED ARE APPROXIMATE DEPICTIONS BASED ON LIMITED SITE INVESTIGATIONS AND GPS LOCATIONS PROVIDED BY WOODLOT ALTERNATIVES, INC.
2. BASE MAP INCLUDING ROAD AND TOPOGRAPHY COMPILED BY AERIAL SURVEY AND PHOTO, INC. OF NORRIDGEWOCK, MAINE.
3. WETLAND LOCATIONS DEPICTED AT THESE AREAS SHOULD BE FIELD VERIFIED PRIOR TO ANY PROPOSED CONSTRUCTION ACTIVITIES.
4. THIS SHEET HAS BEEN PREPARED IN COLOR TO PRESENT ASSOCIATED PHOTOS OF EXISTING CONDITIONS IN THESE AREAS.

PRELIMINARY NOT FOR CONSTRUCTION

| NO. | DATE | REVISIONS |
|-----|----------|--------------------------------|
| 4 | 12.15.05 | REVISED PROJECT TITLE |
| 3 | 08.12.05 | UPDATED ROAD WIDTH AT INSET 5 |
| 2 | 02.22.05 | SUBMITTED TO CLIENT |
| 1 | 02.16.05 | SUBMITTED TO CLIENT FOR REVIEW |

| EXISTING ROAD IMPROVEMENTS INSET AREAS 4 AND 5 | DRAWN: | DATE: | DESIGNED: | SCALE: | CHECKED: | JOB NO. | FILE NAME: |
|--|--------|-------------|-----------|---------|----------|---------|---------------|
| | KEW | AUGUST 2005 | DDA | 1"=100' | WGH | 1708.06 | 1708.06-INSET |

REDINGTON WIND FARM PROJECT
REDINGTON MOUNTAIN WINDPOWER, LLC

DeLuca-Hoffman Associates, Inc.
 778 MAIN STREET, SUITE 8
 SOUTH PORTLAND, ME 04106
 207.775.1121
 WWW.DELUCAHOFFMAN.COM

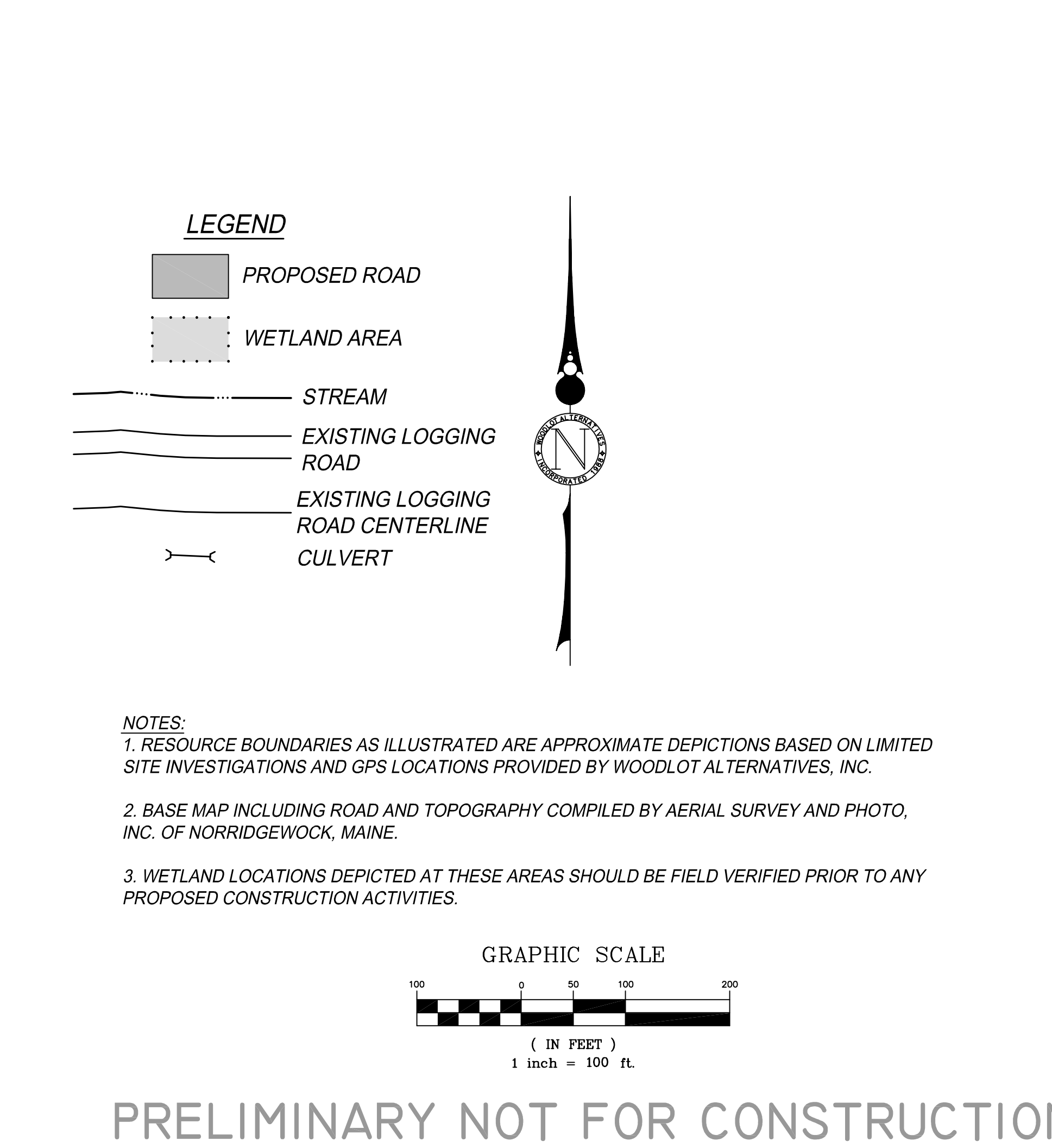
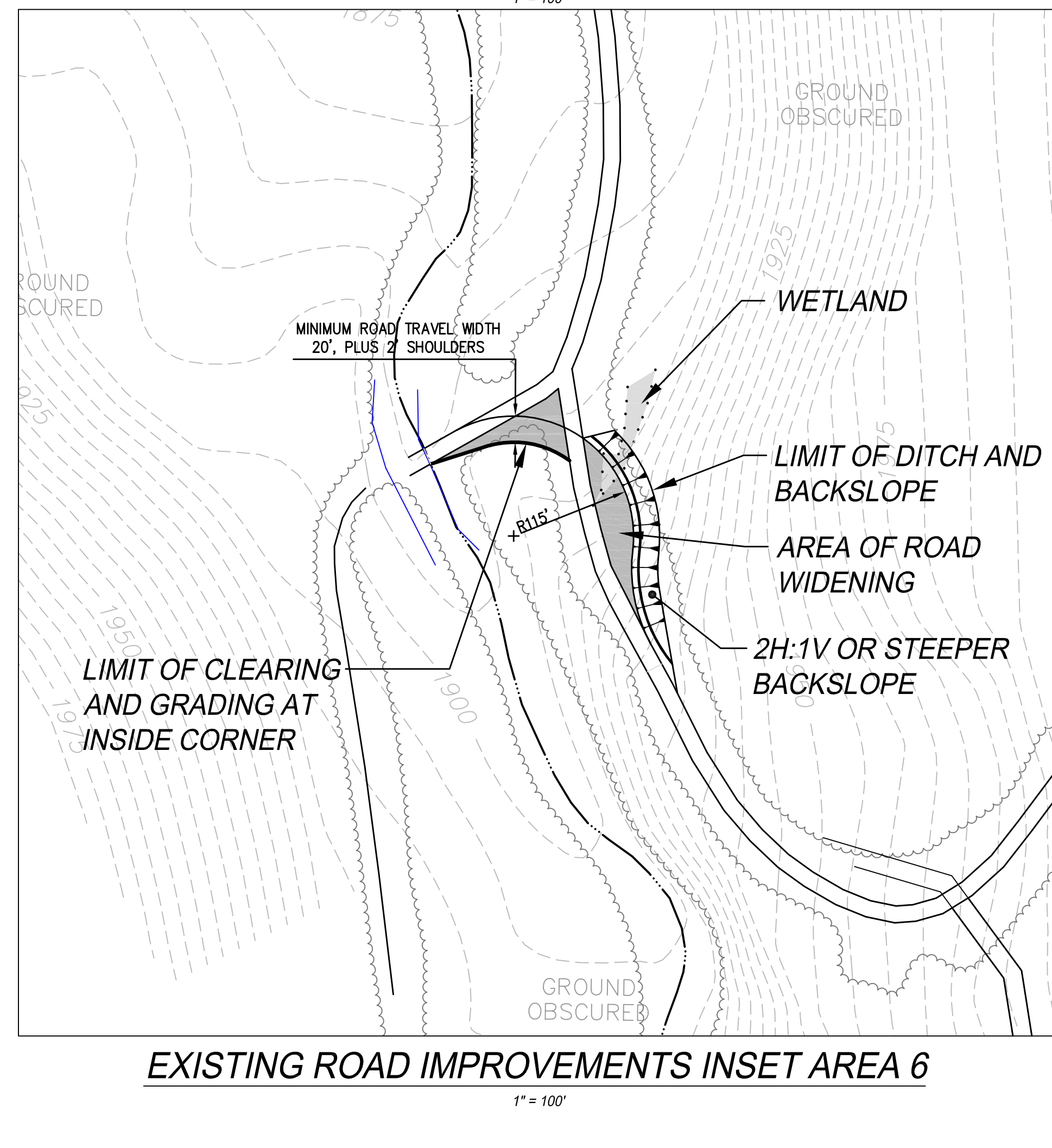
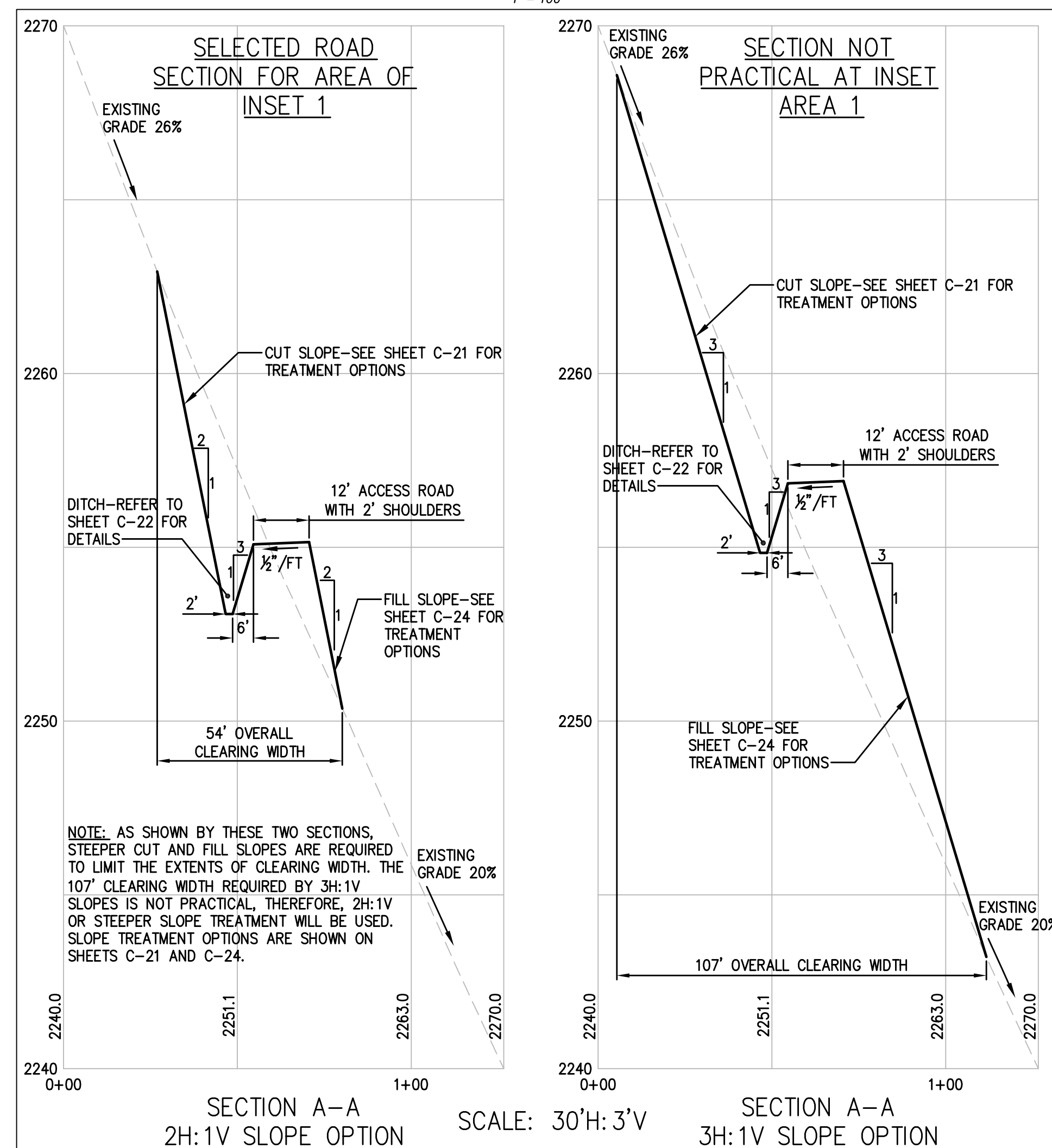
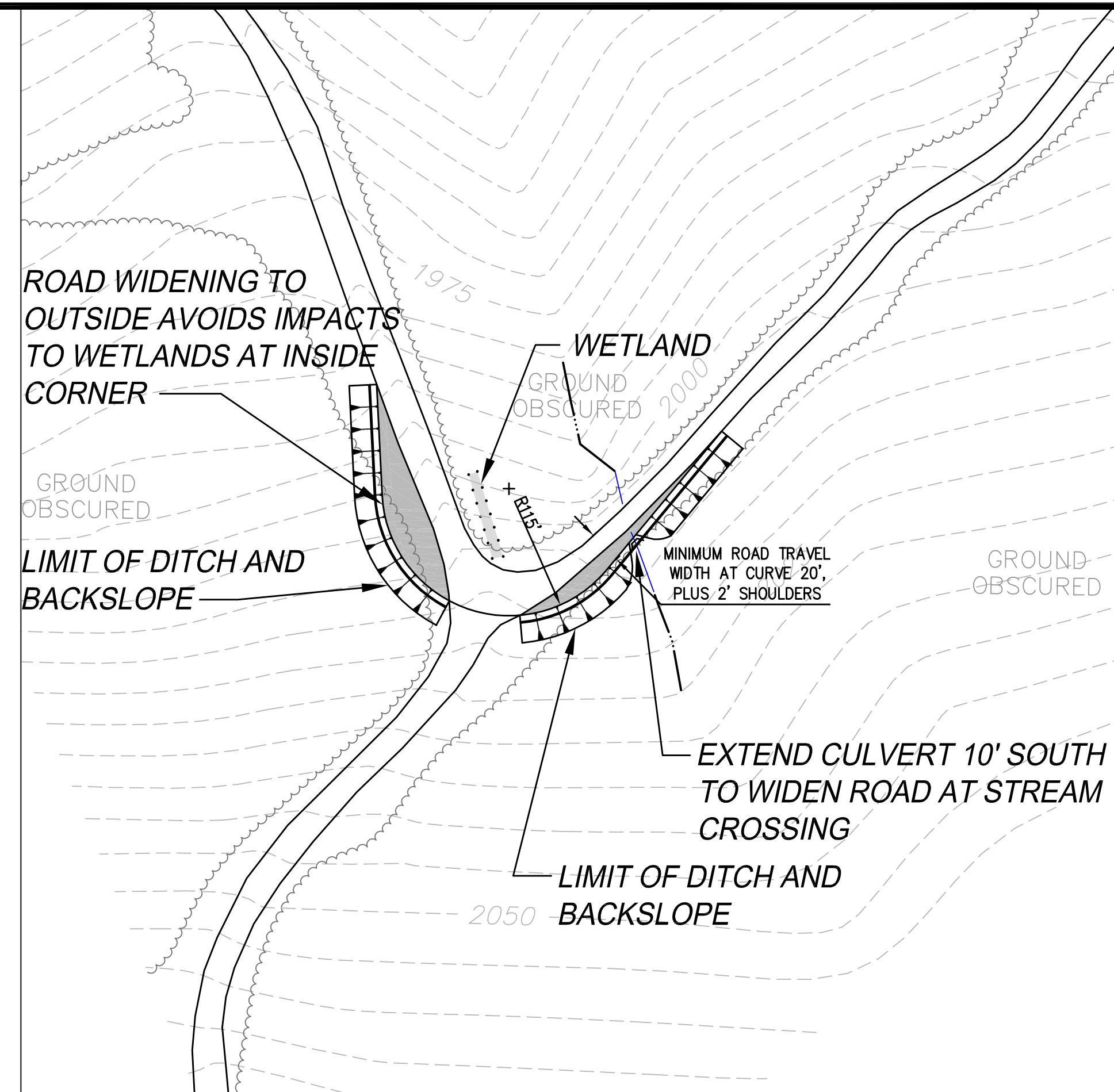
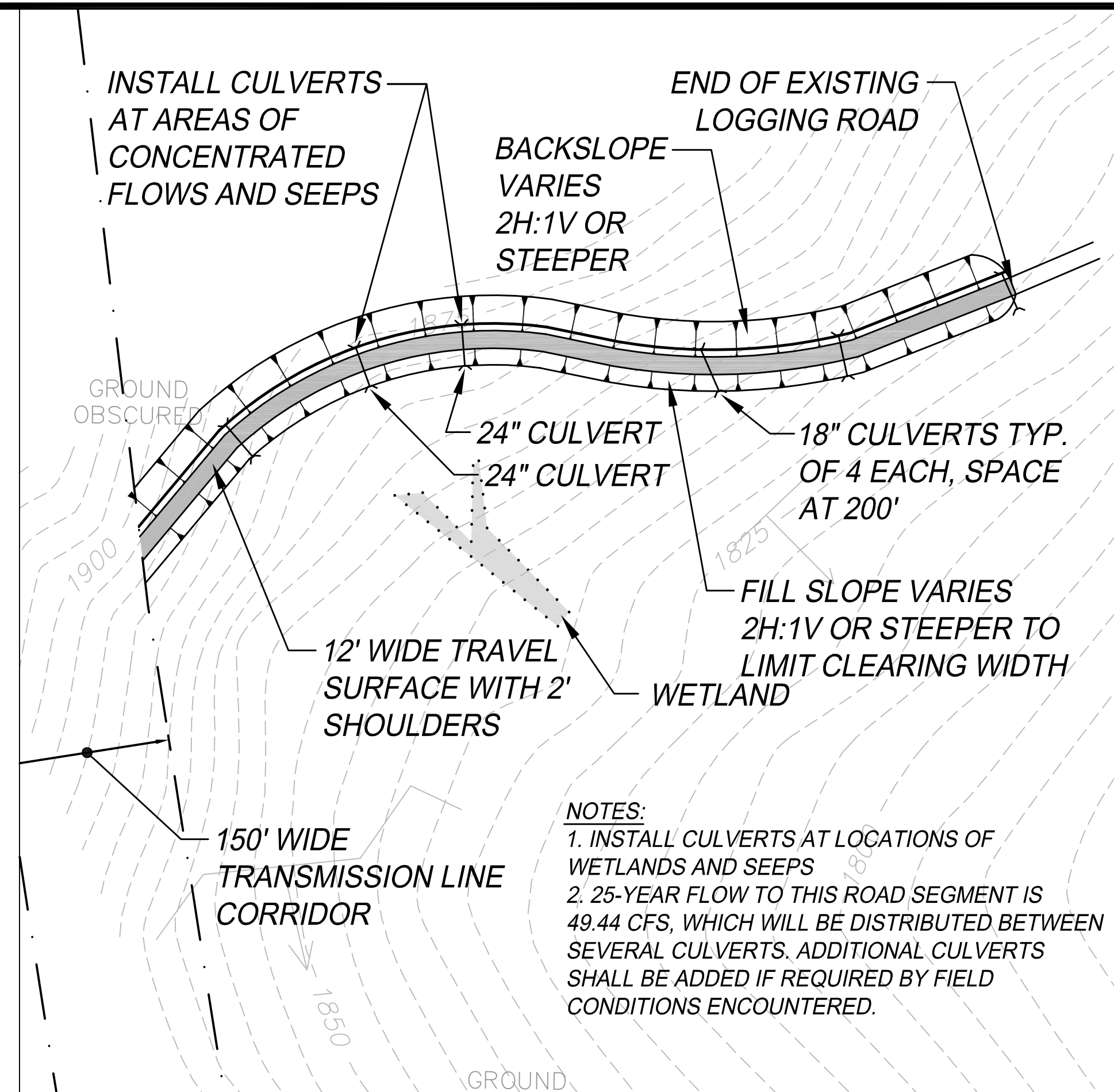
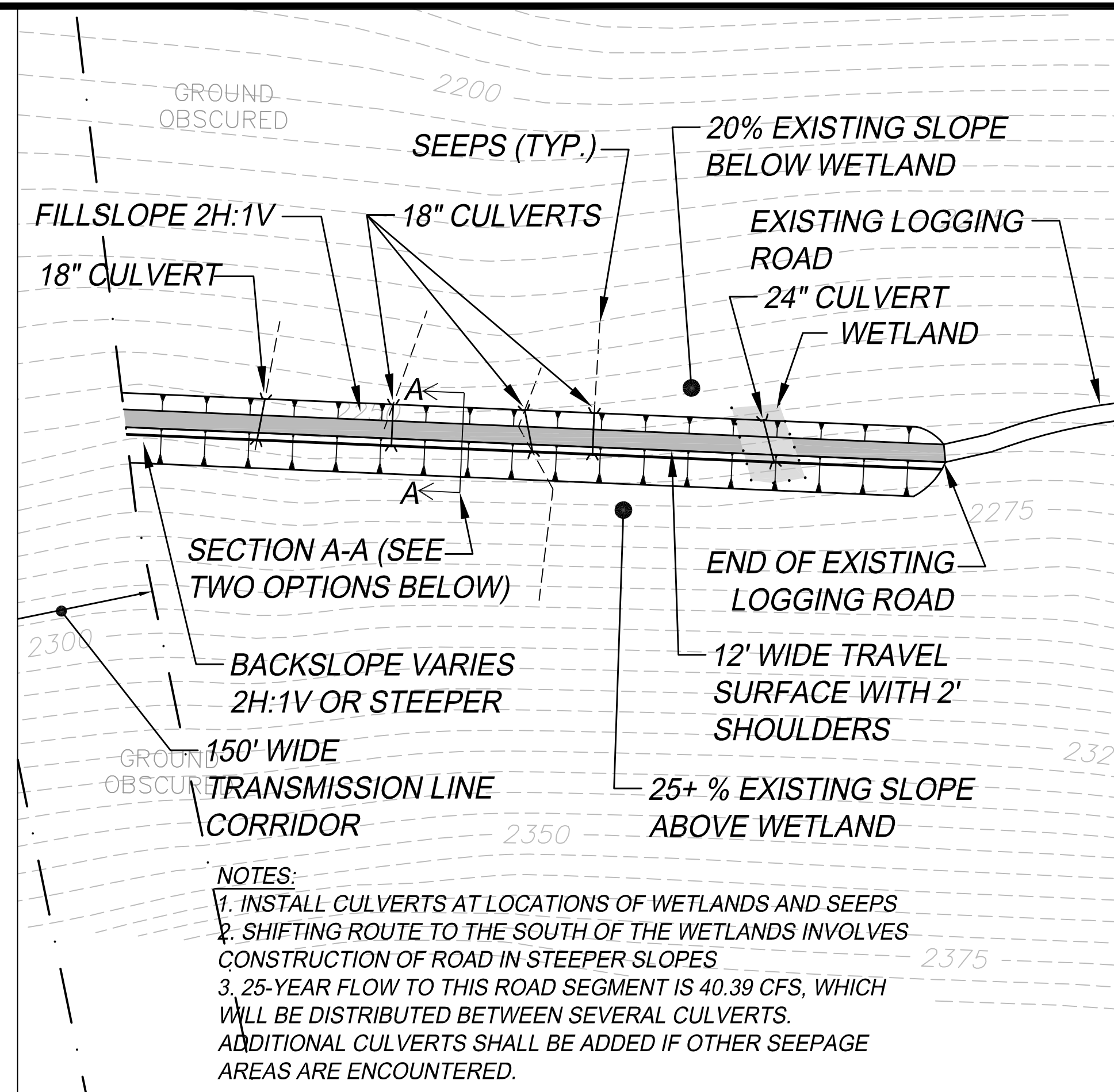

| | | | | |
|--|--|--|-------------------|-----------------------------|
| ACCESS ROUTE EXTENSIONS AND EXISTING ROAD IMPROVEMENTS INSET AREAS 1, 2, 3 AND 6 | | DRAWN: LECJ | DATE: AUGUST 2005 | REVISED PROJECT TITLE |
| | | DESIGNED: DDA | SCALE: 1"=100' | ISSUED TO CLIENT FOR REVIEW |
| | | CHECKED: WGH | JOB NO. 1708.06 | SUBMITTED TO CLIENT |
| | | FILE NAME: 1708.06-INSET | NO. | REVISIONS |
| REDINGTON WIND FARM PROJECT REDINGTON MOUNTAIN WINDPOWER, LLC | | DeLuca-Hoffman Associates, Inc. 778 MAIN STREET, SUITE 8 SOUTH PORTLAND, ME 04106 207.775.1121 WWW.DELUCAHOFFMAN.COM | | |
| SHEET | | 1-2 | | |
| PRELIMINARY NOT FOR CONSTRUCTION | | | | |

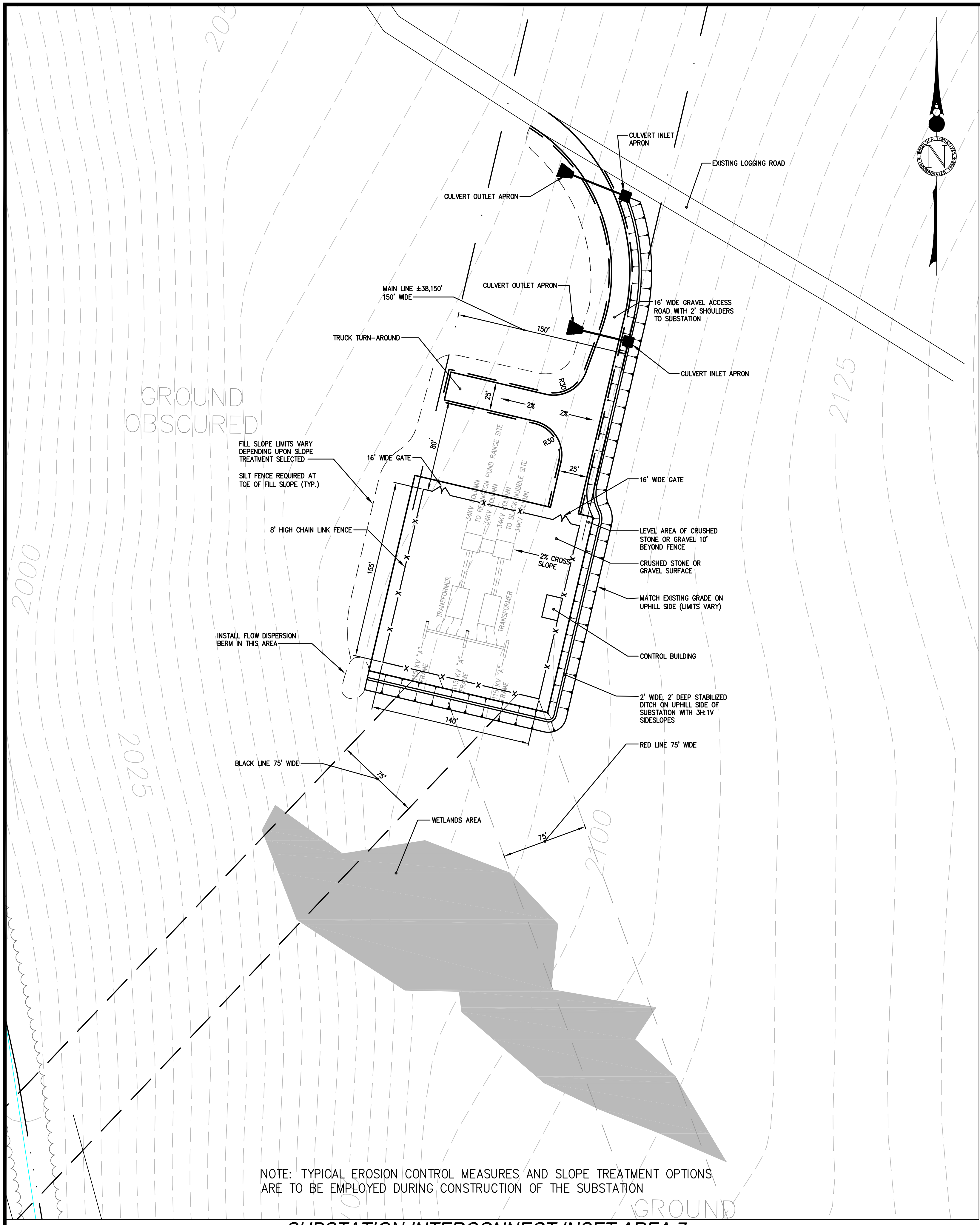

- NOTES:**
1. RESOURCE BOUNDARIES AS ILLUSTRATED ARE APPROXIMATE DEPICTIONS BASED ON LIMITED SITE INVESTIGATIONS AND GPS LOCATIONS PROVIDED BY WOODLOT ALTERNATIVES, INC.
 2. BASE MAP INCLUDING ROAD AND TOPOGRAPHY COMPILED BY AERIAL SURVEY AND PHOTO, INC. OF NORRIDGEWOCK, MAINE.
 3. WETLAND LOCATIONS DEPICTED AT THESE AREAS SHOULD BE FIELD VERIFIED PRIOR TO ANY PROPOSED CONSTRUCTION ACTIVITIES.

LEGEND

WETLAND AREA
 STREAM

NOTE: TYPICAL EROSION CONTROL MEASURES AND SLOPE TREATMENT OPTIONS ARE TO BE EMPLOYED DURING CONSTRUCTION OF THE SUBSTATION

SUBSTATION INTERCONNECT INSET AREA 7

1" = 50'

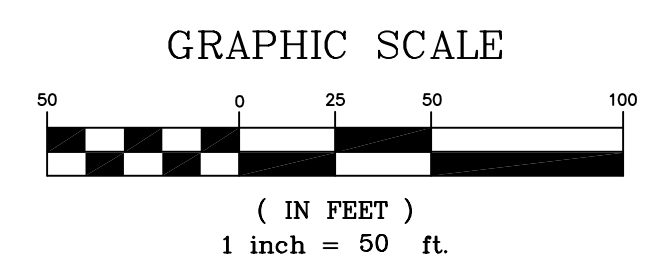

PRELIMINARY NOT FOR CONSTRUCTION

| | | | | |
|--|--|------------|---------------|-----------------------------|
| SUBSTATION INTERCONNECT AND ACCESS ROAD INSET AREA 7 | | NO. | DATE | REVISIONS |
| | | 4 | 12.15.05 | REVISED PROJECT TITLE |
| | | 3 | 08.12.05 | ISSUED TO CLIENT FOR REVIEW |
| | | 2 | 02.22.05 | SUBMITTED TO CLIENT |
| REDINGTON WIND FARM PROJECT REDINGTON MOUNTAIN WINDPOWER, LLC | | FILE NAME: | 1708.06-INSET | |
| | | CHECKED: | WGH | JOB NO. 1708.06 |
| | | DESIGNED: | DDA | SCALE: 1"=50' |
| | | DRAWN: | KEW | DATE: JULY 2005 |
| DeLuca-Hoffman Associates, Inc. 778 MAIN STREET, SUITE 8 SOUTH PORTLAND, ME 04106 207.775.1121 WWW.DELUCAHOFFMAN.COM | | SHEET | | |
| 1-3 | | | | |